

SPARE PARTS BOOK

APPIA
Life.

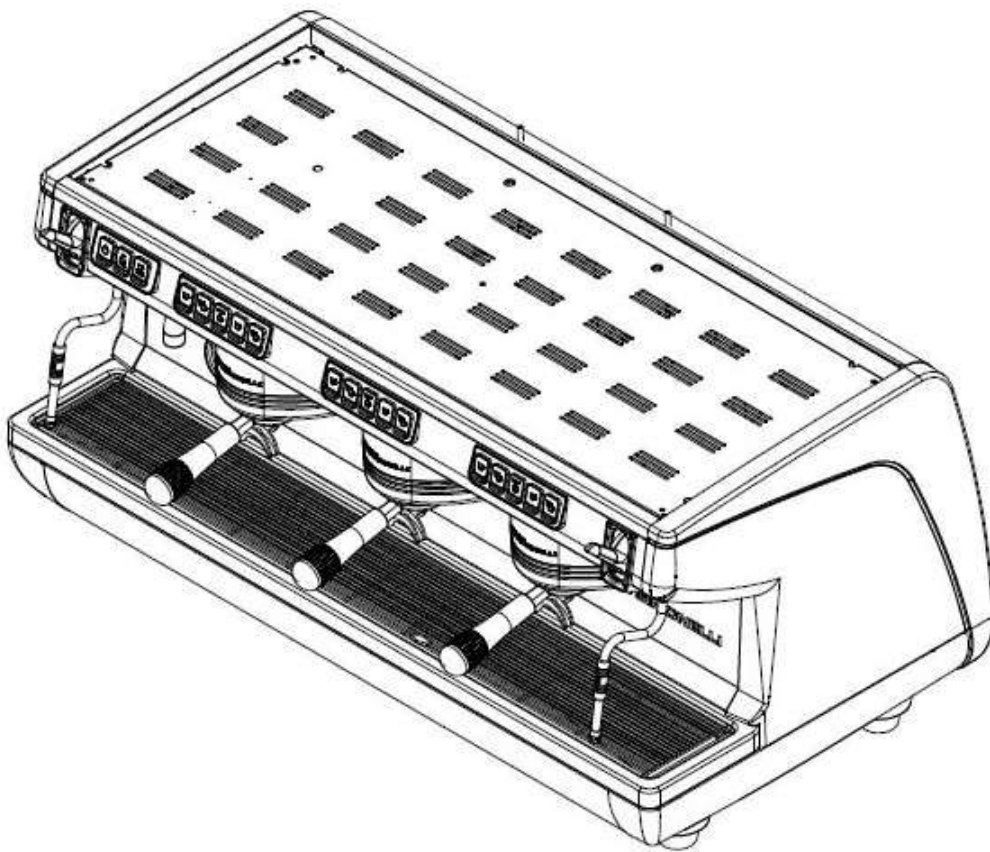

2-3 GR - XT - TIMER

09/11/2023

- T.01 **CABINET PARTS**
COMPONENTI GRUPPO CARENA
- T.02 **CONTROL PANEL ASSEMBLY**
ASSIEME PULSANTIERA
- T.03 **POURING UNIT GROUP PARTS**
COMP. GRUPPO EROGAZIONE
- T.04 **HYDRAULIC PARTS**
COMPONENTI IDRAULICI
- T.05 **STEAM TAPS PARTS**
PARTI RUBINETTI VAPORE
- T.06 **HOT WATER TAPS PARTS**
PARTI RUB. ACQUA CALDA
- T.07 **HYDRAULIC GROUP PARTS**
COMPONENTI GRUPPO IDRAULICO
- T.07 - bis **FLOWMETERS COMPONENTS**
COMPONENTI DOSATORI
- T.08 **BOILER GROUP PARTS**
COMP. GRUPPO CALDAIA
- T.09 **FRAME PARTS**
COMPONENTI TELAIO
- T.10 **EASYCREAM PARTS**
COMPONENTI EASYCREAM
- T.11 **ELECTRICAL PARTS**
COMPONENTI ELETTRICI

» LEGEND :

THE CODES WRITTEN IN BOLD REFER TO THE COMPONENTS
EMPLOYED CURRENTLY.

THE CODES USED BEFORE ARE WRITTEN IN CORSIVE WITH INDICATED,
ON THE SIDE, THE END OF VALIDITY DATE.

EXAMPLE:
03001531 - 01/09/2007
03001531



T.12 **LIGHTS PARTS AND WIFI KIT**
COMPONENTI LUCI E KIT WIFI

» LEGEND :

THE CODES WRITTEN IN BOLD REFER TO THE COMPONENTS
EMPLOYED CURRENTLY.

THE CODES USED BEFORE ARE WRITTEN IN CORSIVE WITH INDICATED,
ON THE SIDE, THE END OF VALIDITY DATE.

EXAMPLE:

03001531 - 01/09/2007

03001531

| CODE | DESCRIPTION |
|----------|---------------------|
| KSE20013 | ELEC. CUPWARMER 2GR |
| KSE30013 | ELEC. CUPWARMER 3GR |

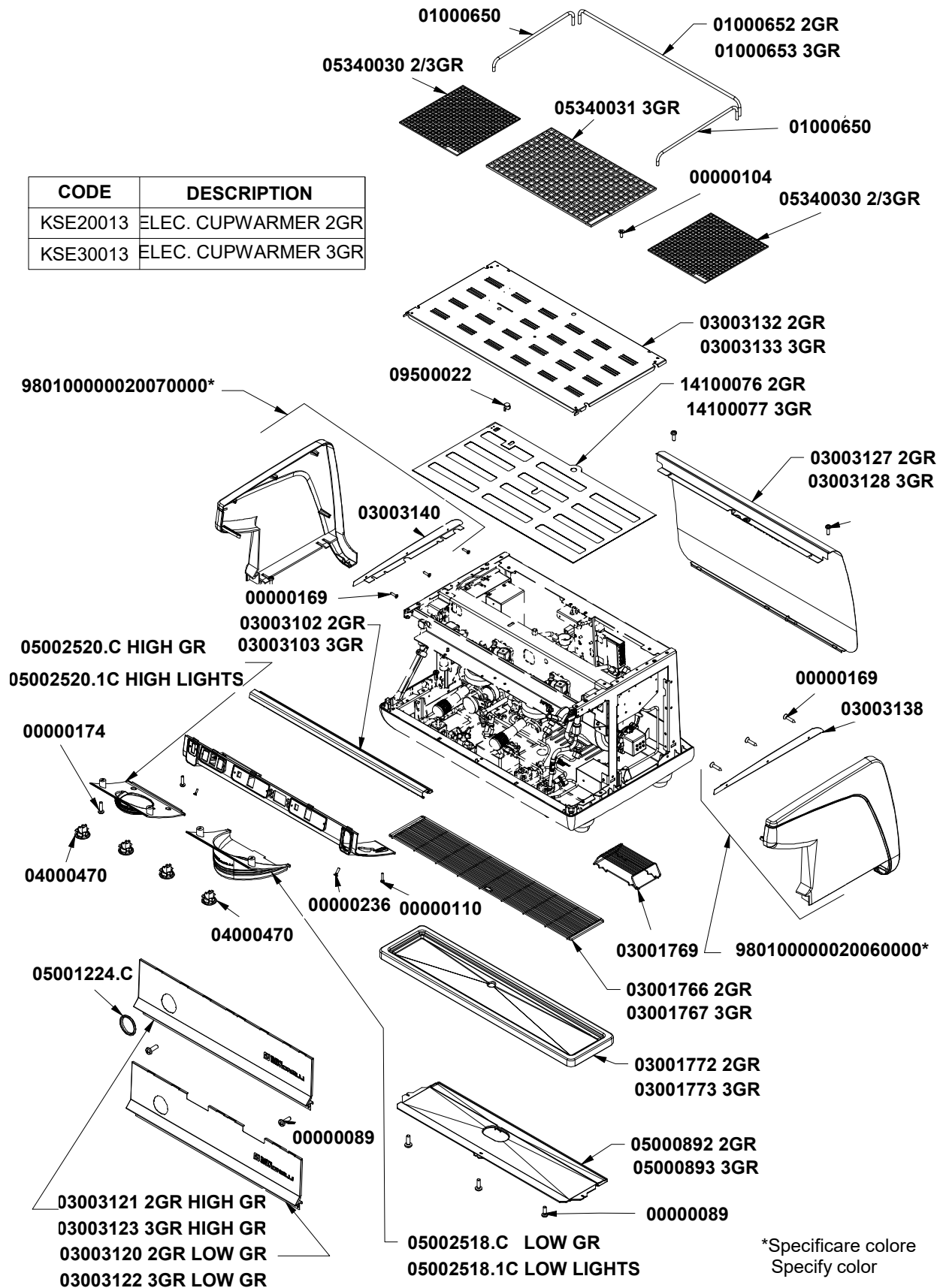

T.01

| COD. | DESCRIPTION | DESCRIZIONE | VAL. |
|-------------|---|---|------|
| 05002518.1C | GROUP COVER LOW GR APPIA19 W/LOGO for LIGHTS CH | COPRIGRUPPO GR. BASSO APPIA19 CON LOGO PER LUCI | |
| 05002520.1C | GROUP COVER RAISED GR APPIA19 W/LOGO-LIGHTS CH | COPRIGRUPPO GR. ALTO APPIA19 CON LOGO PER LUCI | |
| 00000089 | S/S CROSSHEAD CAP SCREW M4x12 DIN7985 | VITE INOX M4x12 TC TCR DIN7985 | |
| 00000104 | S/S CROSSHEAD COUNTERSUNK SCREW M4x10 DIN965 | VITE INOX M4x10 TSP TCR DIN965 | |
| 00000110 | S/S CROSS HEAD CAP SCREW M4x20 7985 | VITE INOX M4x20 TC TCR 7985 | |
| 00000169 | S/S SELF-TAPPING SCREW 2,9x13 TSP/TCR | VITE AUTOF INOX 2,9x13 TSP/TCR | |
| 00000174 | S/S CROSSHEAD CAP SCREW M4x16 | VITE INOX M4x16 TC TCR | |
| 00000236 | S/S SCREW M4X16 TSP TCR | VITE INOX M4x16 TSP TCR | |
| 01000650 | CUPWARMER BACKSIDE TUBE APPIA19 | TUBO LATERALE SCALDATAZZE APPIA19 | |
| 01000652 | CUPWARMER BACKSIDE TUBE APPIA19 2GR | TUBO RETRO SCALDATAZZE APPIA19 2GR. | |
| 01000653 | CUPWARMER BACKSIDE TUBE APPIA19 3GR | TUBO RETRO SCALDATAZZE APPIA19 3GR. | |
| 03001766 | WORKTOP NET 2 GR | RETINA PIANO LAVORO 2 GR. | |
| R03001766 | KIT-WORKTOP NET 2 GR - 1Pcs | KIT-RETINA PIANO LAVORO 2 GR. - 1Pz | |
| 03001767 | WORKTOP NET 3 GR | RETINA PIANO LAVORO 3 GR. | |
| R03001767 | KIT-WORKTOP NET 3 GR-1Pcs | KIT -RETINA PIANO LAVORO 3 GR.-1PZ | |
| 03001769 | S/S RAISED CUP STAND | SUPP. TAZZINE INOX | |
| R03001769 | KIT-S/S RAISED CUP STAND - 1Pcs | KIT-SUPPORTO TAZZINE INOX - 1Pz | |
| 03001772 | DRAIN TRAY 2 GR | PIATTO RACCOGLIACQUA 2 GR. | |
| 03001773 | DRAIN TRAY 3 GR | PIATTO RACCOGLIACQUA 3 GR. | |
| 03003102 | APPIA19 2GROUPS PUSHBUTTON TOP CASE | INVOLUCRO COMANDI 2GR APPIA19 | |
| 03003103 | COMAND BUTTON WRAPPING 2GR APPIA19 | INVOLUCRO COMANDI 3GR APPIA19 | |
| 03003120 | FRONTAL PANEL LOW 2GR APPIA19 | PARETE FRONTALE GR.BASSI 2GR. APPIA19 | |
| 03003121 | FRONTAL PANEL RAISED 2GR APPIA19 | PARETE FRONTALE GR.ALT 2GR. APPIA19 | |
| 03003122 | FRONTAL PANEL LOW 3GR APPIA19 | PARETE FRONTALE GR.BASSI 3GR. APPIA19 | |
| 03003123 | FRONTAL PANEL RAISED 3GR APPIA19 | PARETE FRONTALE GR.ALT 3GR. APPIA19 | |
| 03003127 | REAR COVER 2GR APPIA19 | CARENA RETRO 2GR. APPIA19 | |
| 03003128 | REAR COVER 3GR APPIA19 | CARENA RETRO 3GR. APPIA19 | |
| 03003132 | CUP HOLDER PLATE 2GR APPIA19 | PIATTO PORTATAZZE 2GR APPIA19 | |
| 03003133 | CUP HOLDER PLATE 3GR APPIA19 | PIATTO PORTATAZZE 3GR APPIA19 | |
| 03003138 | RIGHT SIDE SUPERIOR COVER APPIA19 | MOSTRINA SUP. FIANCO DX APPIA19 | |
| 03003140 | LEFT SIDE SUPERIOR COVER APPIA19 | MOSTRINA SUP. FIANCO SX APPIA19 | |
| 04000470 | 12VDC LED SPOT AURELIA WAVE | LED AURELIA18 12V | |
| R04000470 | KIT-12VDC LED SPOT AURELIA WAVE-2Pcs | KIT -LED AURELIA18 12V-2PZ | |
| 05000892 | SAFETY COVER WORKTOP 2 ABS | CHIUSURA SICUR. PIANO LAVORO 2 ABS | |
| R05000892 | KIT-SAFETY COVER WORKTOP 2 ABS - 1Pcs | KIT-CHIUSURA SICUR. PIANO LAVORO 2 ABS - 1Pz | |
| 05000893 | SAFETY COVER WORKTOP 3 ABS | CHIUSURA SICUR. PIANO LAVORO 3 ABS | |
| R05000893 | KIT-SAFETY COVER WORKTOP 3 ABS - 1Pcs | KIT-CHIUSURA SICUR. PIANO LAVORO 3 ABS - 1Pz | |
| 05001224.C | WATER GAUGE PLATE AURELIA II CHROME | MOSTRINA MANOMETRO AURELIA II CROMATA | |
| 05002518.C | GROUP COVER LOW GR APPIA19 W/LOGO CHROME | COPRIGRUPPO GR. BASSO APPIA19 CON LOGO CROMATI | |
| 05002520.C | GROUP COVER RAISED GR APPIA19 W/LOGO CHROME | COPRIGRUPPO GR. ALTO APPIA19 CON LOGO CROMATO | |
| 05340030 | NYLON GRILL 370x335 | GRIGLIA MODULO 370x335 | |
| R05340030 | KIT-NYLON GRILL 370x335 - 2Pcs | KIT-GRIGLIA MODULO 370x335 - 2Pz | |
| 05340031 | NYLON GRILL 370x230 | GRIGLIA MODULO 370x230 | |
| R05340031 | KIT-NYLON GRILL 370x230 - 2Pcs | KIT-GRIGLIA MODULO 370x230 - 2Pz | |
| 09500022 | AUTOMATIC THERMOSTAT 75°C BROWN DRIPPING | TERMOSTATO R.AUT. 75°C GOCCIOLATURA MARRONE | |

APPIA 2-3 GR-XT-TIMER
Life. 2-3 GR-XT-TIMER

COMPONENTI GRUPPO CARENA
CABINET PARTS

| COD. | DESCRIPTION | DESCRIZIONE | VAL. |
|--------------------|---|---|------|
| 14100076 | CUP-WARMER ADHESIVE RESISTANCE APPIA19 2GR. | RESISTENZA ADESIVA SCALDATAZZE APPIA19 2GR. | |
| 14100077 | CUP-WARMER ADHESIVE RESISTANCE APPIA19 3GR. | RESISTENZA ADESIVA SCALDATAZZE APPIA19 3GR. | |
| 980100000020060001 | RIGHT SIDE PANEL SET BLACK | ASS. FIANCO DX NERO | |
| 980100000020060002 | RIGHT SIDE PANEL SET WHITE | ASS. FIANCO DX BIANCO | |
| 980100000020060003 | RIGHT SIDE PANEL SET RED | ASS. FIANCO DX ROSSO | |
| 980100000020060004 | RIGHT SIDE PANEL SET MATT BLACK | ASS. FIANCO DX NERO OPACO | |
| 980100000020070001 | LEFT SIDE PANEL SET BLACK | ASS. FIANCO SX NERO | |
| 980100000020070002 | LEFT SIDE PANEL SET WHITE | ASS. FIANCO SX BIANCO | |
| 980100000020070003 | LEFT SIDE PANEL SET RED | ASS. FIANCO SX ROSSO | |
| 980100000020070004 | LEFT SIDE PANEL SET MATT BLACK | ASS. FIANCO SX NERO OPACO | |
| KSE20013 | ELECTRICAL CUPWARMER APPIA LIFE 2GR | SCALDATAZZE ELETTRICO APPIA LIFE 2GR. | |
| KSE30013 | ELECTRICAL CUPWARMER APPIA LIFE 3GR | SCALDATAZZE ELETTRICO APPIA LIFE 3GR. | |

APPIA *Life.*

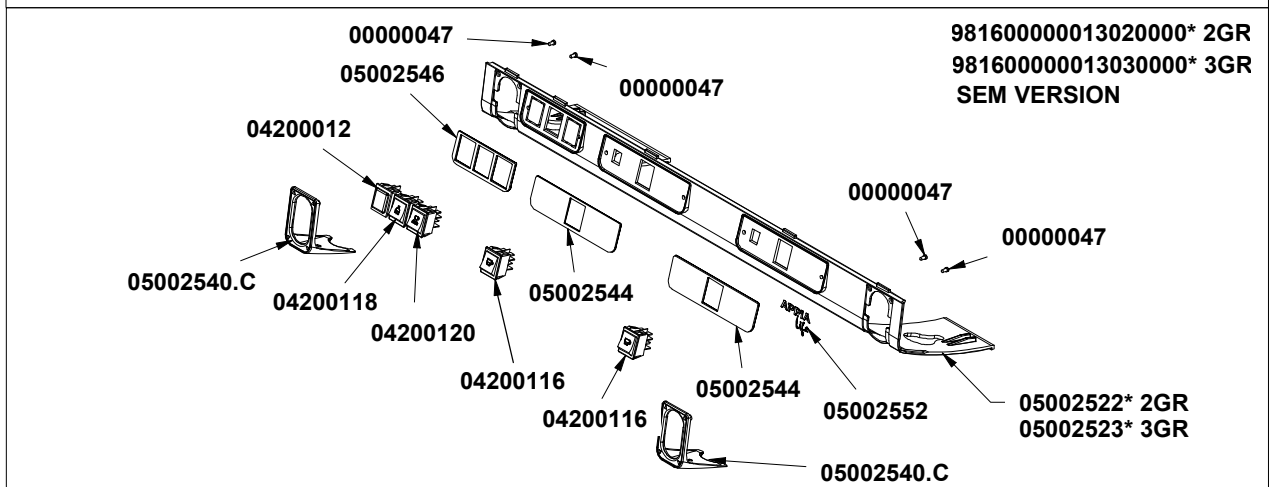
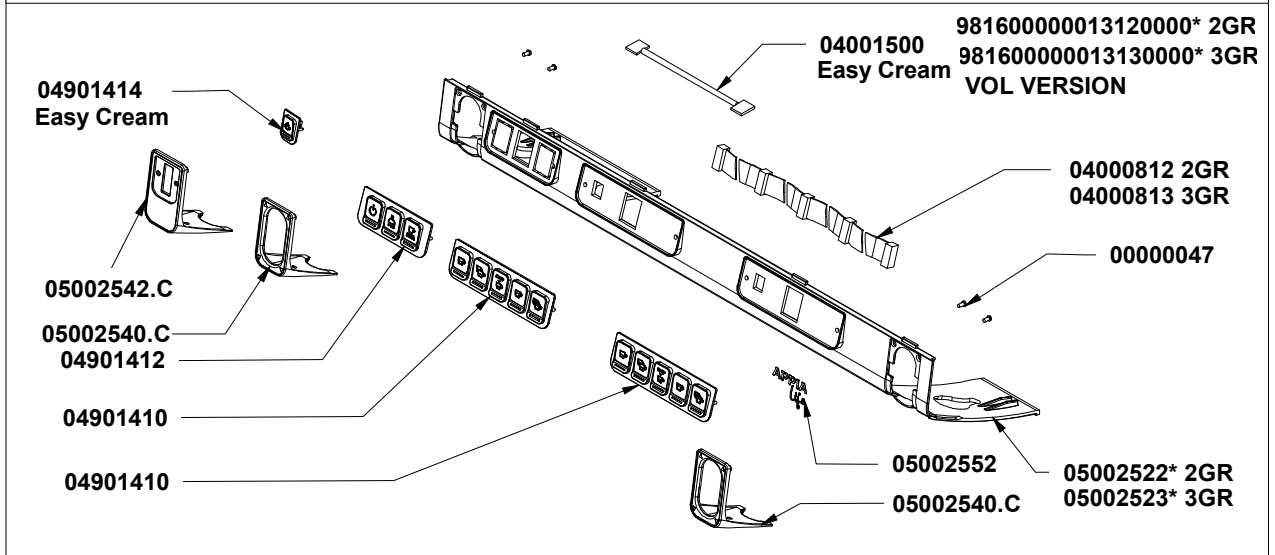
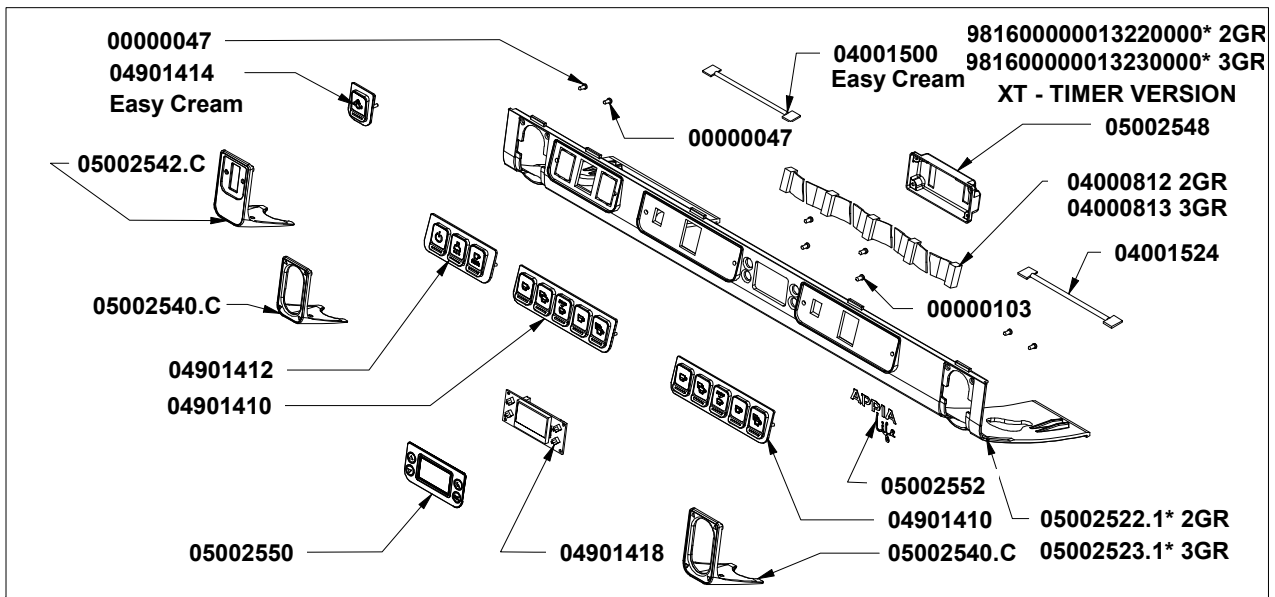

* Specificare versione
 Specify version

| COD. | DESCRIPTION | DESCRIZIONE | VAL. |
|--------------------|--|---|------|
| 00000047 | CROSS HEAD/CAP SELF-TAPPING SCREW 2,9x6,5 | VITE AUTOF 2,9x6,5 TC/T.CR. | |
| 00000103 | GALV SELF-TAPP. CROSS HEAD CAP SCREW 3.9x6.5 | VITE AUTOF 3,9x6,5 TC T.CR.ZIN | |
| 04000812 | CABLE 14 WAY KEYPAD 2GR APPIA + SHEATH | CAVO 14 VIE COLL.PULSANTIERA 2GR APPIA + GUAINA | |
| R04000812 | KIT-CABLE 14 WAY KEYPAD 2GR + SHEATH - 2Pcs | KIT-CAVO 14 VIE COLL.PULSANTIERA 2GR - 2Pz | |
| 04000813 | CABLE 14 WAY KEYPAD 3GR APPIA + SHEATH | CAVO 14 VIE COLL.PULSANTIERA 3GR APPIA + GUAINA | |
| R04000813 | KIT-CABLE 14 WAY KEYPAD 3GR + SHEATH - 2Pcs | KIT-CAVO 14 VIE COLL.PULSANTIERA 3GR - 2Pz | |
| 04001500 | CONNECTION CABLE REMOTE KEY - CENTRAL BOARD A | CAVO COLL. TASTO REMOTO - CENTRALINA APPIA19 EAS | |
| 04001524 | CONN CABLE DISPLAY-CENTRAL BOARD APPIA19 | CAVO COLL. DISPLAY-CENTRALINA APPIA19 | |
| 04200012 | RED FLASHING SEGNA SYSTEM UL | SEGNALATORE LUMINOSO ROSSO RETTANGOLARE UL | |
| 04200116 | BLUE LIGHT WHITE BIPOLAR SWITCH UL 16A COFFEE | INTERRUTTORE BIPOLARE LUMINOSO BIANCO RETTANGOLARE UL | |
| 04200118 | BLUE LIGHT WHITE BIPOLAR SWITCH UL 16A HOTWATER | INTERRUTTORE BIPOLARE LUMINOSO BIANCO RETTANGOLARE UL | |
| 04200120 | BLUE LIGHT WHITE BIPOLAR SWITCH UL 16A CUPWARM | INTERRUTTORE BIPOLARE LUMINOSO BIANCO RETTANGOLARE UL | |
| 04901410 | 5KEY DISPENSING KEYPAD APPIA19 V | SCHEDA EROG. 5 TASTI APPIA19 V | |
| R04901410 | KIT-5KEY DISPENSING KEYPAD APPIA19 V-1Pcs | KIT -SCHEDA EROG. 5 TASTI APPIA19 V-1PZ | |
| 04901412 | 3KEY DISPENSING KEYPAD APPIA19 V | SCHEDA SERV. 3 TASTI APPIA19 V | |
| R04901412 | KIT-3KEY DISPENSING KEYPAD APPIA19 V-1Pcs | KIT -SCHEDA SERV. 3 TASTI APPIA19 V-1PZ | |
| 04901414 | STEAM DISPENSING KEY APPIA19 V | SCHEDA EROGAZ. 1 TASTO VAPORE APPIA19 V | |
| R04901414 | KIT-STEAM DISPENSING KEY APPIA19 V-1Pcs | KIT -SCHEDA EROGAZ. 1 TASTO VAPORE APPIA19 V-1PZ | |
| 04901418 | DISPLAY BOARD APPIA19 XT | SCHEDA DISPLAY APPIA19 XT | |
| 05002522.N | KEYPAD 2GR APPIA19 BLACK | PULSANTIERA 2GR. APPIA19 NERO FOTOINCISO | |
| 05002522.NOV | KEYPAD 2GR APPIA19 PAINTED MATT BLACK | PULSANTIERA 2GR. APPIA19 NERO OPACO VERNICIATO | |
| 05002522.RV | KEYPAD 2GR APPIA19 PAINTED RED | PULSANTIERA 2GR. APPIA19 ROSSO VERNICIATO | |
| 05002522.1BV | KEYPAD 2GR APPIA19 W/ DISPL. OPENING PAINTED WHITE | PULSANTIERA 2GR. APPIA19 CON APERTURA DISPLAYBIANCO | |
| 05002522.1NOV | KEYPAD 2GR APPIA19 W/DISPL OPENING PAINT MATTE BLACK | PULSANTIERA 2GR. APPIA19 CON APERTURA DISPLAY NERO | |
| 05002522.1RV | KEYPAD 2GR APPIA19 WDISPLAY OPENING PAINTED RED | PULSANTIERA 2GR. APPIA19 CON APERTURA DISPLAYROSSO | |
| 05002523.BV | KEYPAD 3GR APPIA19 PAINTED WHITE | PULSANTIERA 3GR. APPIA19 BIANCO VERNICIATO | |
| 05002523.NOV | KEYPAD 3GR APPIA19 PAINTED MATTE BLACK | PULSANTIERA 3GR. APPIA19 NERO OPACO VERNICIATO | |
| 05002523.RV | KEYPAD 3GR APPIA19 PAINTED RED | PULSANTIERA 3GR. APPIA19 ROSSO VERNICIATO | |
| 05002523.1BV | KEYPAD 3GR APPIA19 W/DISPLAY OPENING PAINTED WHITE | PULSANTIERA 3GR. APPIA19 CON APERTURA DISPLAYBIANCO | |
| 05002523.1NOV | KEYPAD 3GR APPIA19 W/DISPLAY OPENING PAINTED MATTE BLACK | PULSANTIERA 3GR. APPIA19 CON APERTURA DISPLAY NERO | |
| 05002523.1RV | KEYPAD 3GR APPIA19 W/DISPLAY OPENING PAINTED RED | PULSANTIERA 3GR. APPIA19 CON APERTURA DISPLAYROSSO | |
| 05002540.C | APPIA19 STEAM KNOB CHROME PLATED COVER | MOSTRINA MANOPOLA VAPORE APPIA19 CROMATA | |
| 05002542.C | APPIA19 EASYCREAM CHROME PLATED COVER | MOSTRINA PULSANTE EASY CREAM APPIA19 CROMATA | |
| 05002544 | DISPENSING KEY COVER APPIA19S | MOSTRINA TASTO EROG. APPIA19 S | |
| 05002546 | SERVICE KEYS COVER APPIA19S | MOSTRINA TASTI SERV. APPIA19 S | |
| 05002548 | DISPLAY BOARD CLOSURE APPIA19 V | CHIUSURA SCHEDA DISPLAY APPIA19 V | |
| 05002550 | DISPLAY BOARD KEY FILM APPIA19 V | PELLICOLA PULSANTI SCHEDA DISPLAY APPIA19 V | |
| 05002552 | APPIA LIFE ADHESIVE CHROME PLATED LABEL METALFLEX | ETICHETTA AD "APPIA LIFE" METALFLEX CROMO | |
| 981600000013020001 | PUSHBUTTON PANEL ASSEMBLY 2GR SEM BLACK | ASS. PULSANT. COMP. 2GR SEM NERO | |
| 981600000013020002 | PUSHBUTTON PANEL ASSEMBLY 2GR SEM WHITE | ASS. PULSANT. COMP. 2GR SEM BIANCO | |
| 981600000013020003 | PUSHBUTTON PANEL ASSEMBLY 2GR SEM RED | ASS. PULSANT. COMP. 2GR SEM ROSSO | |
| 981600000013020004 | PUSHBUTTON PANEL ASSEMBLY 2GR SEM MATT BLACK | ASS. PULSANT. COMP. 2GR SEM NERO OPACO | |
| 981600000013030001 | PUSHBUTTON PANEL ASSEMBLY 3GR SEM MATT BLACK | ASS. PULSANT. COMP. 3GR SEM NERO | |
| 981600000013030002 | PUSHBUTTON PANEL ASSEMBLY 3GR SEM WHITE | ASS. PULSANT. COMP. 3GR SEM BIANCO | |
| 981600000013030003 | PUSHBUTTON PANEL ASSEMBLY 3GR SEM RED | ASS. PULSANT. COMP. 3GR SEM ROSSO | |

| COD. | DESCRIPTION | DESCRIZIONE | VAL. |
|-------------------|--|--|------|
| 98160000013120001 | COMPLETE KEYPAD SET 2GR VOL BLACK | ASS. PULSANT.COMP. 2GR VOL NERO | |
| 98160000013120002 | COMPLETE KEYPAD SET 2GR VOL WHITE | ASS. PULSANT.COMP. 2GR VOL BIANCO | |
| 98160000013120003 | COMPLETE KEYPAD SET 2GR VOL RED | ASS. PULSANT.COMP. 2GR VOL ROSSO | |
| 98160000013120004 | COMPLETE KEYPAD SET 2GR VOL EC RIGHT BLACK | ASS. PULSANT.COMP. 2GR VOL EASY CREAM DX NERO | |
| 98160000013120005 | COMPLETE KEYPAD SET 2GR VOL EC RIGHT WHITE | ASS. PULSANT.COMP. 2GR VOL EASY CREAM DX BIANCO | |
| 98160000013120006 | COMPLETE KEYPAD SET 2GR VOL EC RIGHT RED | ASS. PULSANT.COMP. 2GR VOL EASY CREAM DX ROSSO | |
| 98160000013120007 | COMPLETE KEYPAD SET 2GR VOL EC LEFT BLACK | ASS. PULSANT.COMP. 2GR VOL EASY CREAM SX NERO | |
| 98160000013120008 | COMPLETE KEYPAD SET 2GR VOL EC RIGHT WHITE | ASS. PULSANT.COMP. 2GR VOL EASY CREAM SX BIANCO | |
| 98160000013120009 | COMPLETE KEYPAD SET 2GR VOL EC LEFT RED | ASS. PULSANT.COMP. 2GR VOL EASY CREAM SX ROSSO | |
| 98160000013120010 | COMPLETE KEYPAD SET 2GR VOL TC LEFT BLACK | ASS. PULSANT.COMP. 2GR VOL NERO OPACO | |
| 98160000013120011 | COMPLETE KEYPAD SET 2GR VOL MATT BLACK | ASS. PULSANT.COMP. 2GR VOL EC DX NERO OPACO | |
| 98160000013120012 | PUSHBUTTON PANEL 2GR VOL EC RIGHT MATT BLACK | ASS. PULSANT.COMP. 2GR VOL EC SX NERO OPACO | |
| 98160000013130001 | PUSHBUTTON PANEL 3GR VOL MATT BLACK | ASS. PULSANT.COMP. 3GR VOL NERO OPACO | |
| 98160000013130002 | PUSHBUTTON PANEL 3GR VOL WHITE | ASS. PULSANT.COMP. 3GR VOL BIANCO | |
| 98160000013130003 | PUSHBUTTON PANEL 3GR VOL RED | ASS. PULSANT.COMP. 3GR VOL ROSSO | |
| 98160000013130004 | PUSHBUTTON PANEL 3GR VOL EC RIGHT MATT BLACK | ASS. PULSANT.COMP. 3GR VOL EC DX NERO OPACO | |
| 98160000013130005 | PUSHBUTTON PANEL 3GR VOL EC RIGHT WHITE | ASS. PULSANT.COMP. 3GR VOL EC DX BIANCO | |
| 98160000013130006 | PUSHBUTTON PANEL 3GR VOL EC RIGHT RED | ASS. PULSANT.COMP. 3GR VOL EC DX ROSSO | |
| 98160000013220001 | COMPLETE KEYPAD SET 2GR MATT BLACK | ASS. PULSANT.COMP. 2GR XT NERO OPACO | |
| 98160000013220002 | COMPLETE KEYPAD SET 2GR WHITE | ASS. PULSANT.COMP. 2GR XT BIANCO | |
| 98160000013220003 | COMPLETE KEYPAD SET 2GR RED | ASS. PULSANT.COMP. 2GR XT ROSSO | |
| 98160000013220004 | COMPLETE KEYPAD SET 2GR EC RIGHT WHITE | ASS. PULSANT.COMP. 2GR XT EASY CREAM DX BIANCO | |
| 98160000013220005 | COMPLETE KEYPAD SET 2GR EC RIGHT RED | ASS. PULSANT.COMP. 2GR XT EASY CREAM DX ROSSO | |
| 98160000013220006 | COMPLETE KEYPAD SET 2GR EC RIGHT MATT BLACK | ASS. PULSANT.COMP. 2GR XT EASY CREAM DX NERO OP. | |
| 98160000013220007 | COMPLETE KEYPAD SET 2GR EC LEFT WHITE | ASS. PULSANT.COMP. 2GR XT EASY CREAM SX BIANCO | |
| 98160000013220008 | COMPLETE KEYPAD SET 2GR EC LEFT RED | ASS. PULSANT.COMP. 2GR XT EASY CREAM SX ROSSO | |
| 98160000013220009 | COMPLETE KEYPAD SET 2GR EC LEFT MATT BLACK | ASS. PULSANT.COMP. 2GR XT EASY CREAM SX NERO OP. | |
| 98160000013230001 | COMPLETE KEYPAD SET 3GR XT MATT BLACK | ASS. PULSANT.COMP. 3GR XT NERO OPACO | |
| 98160000013230002 | COMPLETE KEYPAD SET 3GR XT WHITE | ASS. PULSANT.COMP. 3GR XT BIANCO | |
| 98160000013230003 | COMPLETE KEYPAD SET 3GR XT RED | ASS. PULSANT.COMP. 3GR XT ROSSO | |
| 98160000013230004 | COMPLETE KEYPAD SET 3GR XT EC RIGHT WHITE | ASS. PULSANT.COMP. 3GR XT EC DX BIANCO | |
| 98160000013230005 | COMPLETE KEYPAD SET 3GR XT EC RIGHT RED | ASS. PULSANT.COMP. 3GR XT EC DX ROSSO | |
| 98160000013230006 | COMPLETE KEYPAD SET 3GR XT EC RIGHT MATT BLACK | ASS. PULSANT.COMP. 3GR XT EC DX NERO OPACO | |
| 98160000013230007 | COMPLETE KEYPAD SET 3GR XT EC LEFT MATT BLACK | ASS. PULSANT.COMP. 3GR XT EC SX NERO OPACO | |

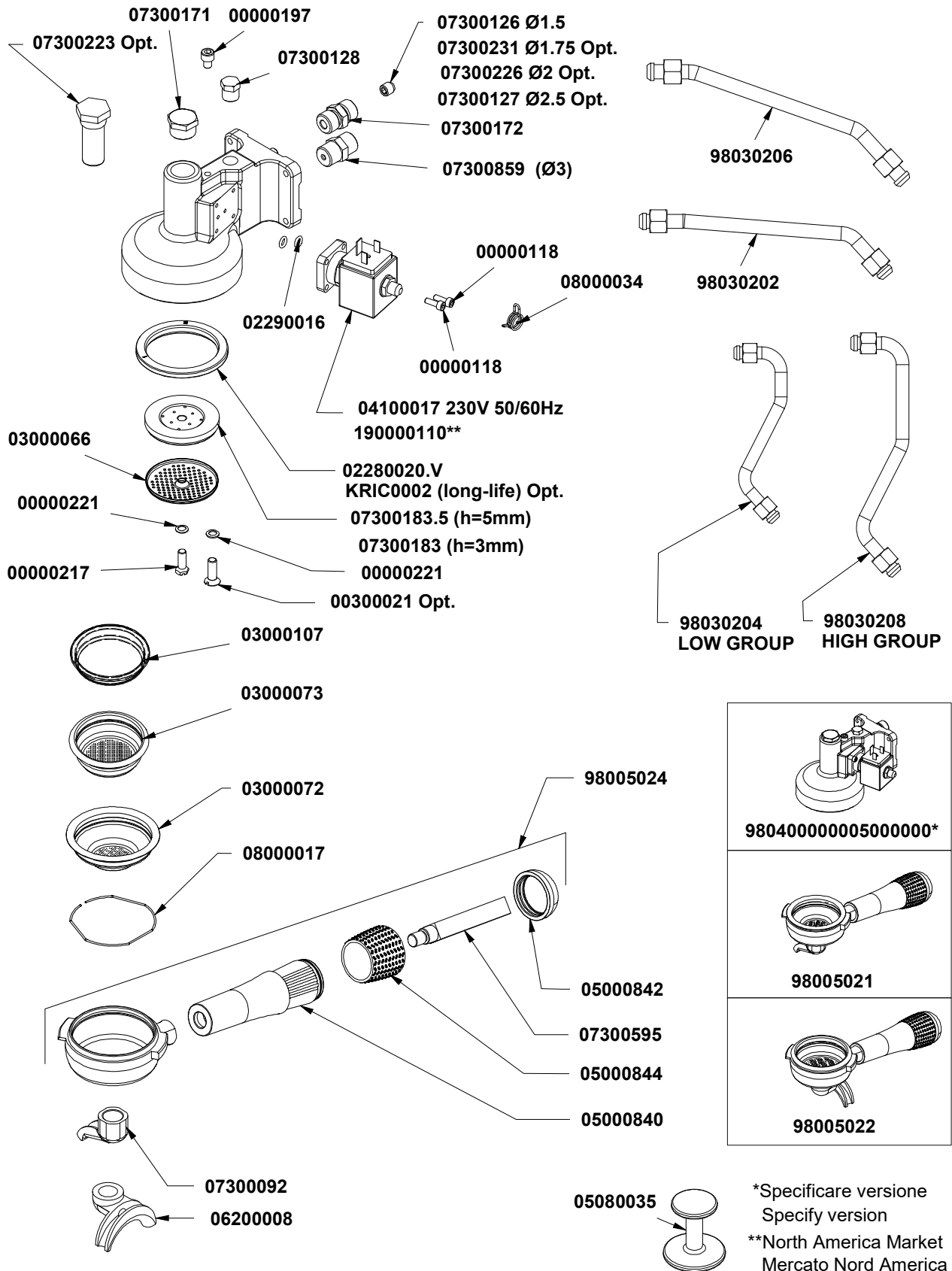

*Specificare versione
 Specify version
 **North America Market
 Mercato Nord America

| COD. | DESCRIPTION | DESCRIZIONE | VAL. |
|-------------|---|---|------|
| 00000118 | S/SHEX SOCKET CAP SCREW M4x12 5931 | VITE INOX M4x12 TCEI 5931 | |
| 00000197 | S/S HEX SOCKET CAP SCREW M6x8 ISO 4762 | VITE INOX M6x8 TCEI ISO 4762 | |
| 00000217 | S/S SCREW TE CH9 + TC LT=20 FOR SHOWER | VITE INOX M6 LT=20 TE CH9 + TCx DOCCIA | |
| R00000217 | KIT-S/S SCREW TE CH9 + TC LT=20 FOR SHOWER - 10Pcs | KIT-VITE INOX M6 LT=20 + TCx DOCCIA - 10Pz | |
| 00000221 | S/S SECURITY FLAT WASHER INOX M6 CONICAL | RONDELLA DI SICUREZZA INOX M6 SCHNORR CONICA | |
| 00300021 | S/S SLT COUNTERSUNK SCREW M6X18 DIN963 | VITE INOX M6x18 TSP TC DIN963 | |
| R00300021 | KIT-S/S SLT COUNTERSUNK SCREW M6X18 - 30Pcs | KIT-VITE INOX M6x18 - 30Pz | |
| 02280020.V | CONICAL GROUP GASKET | GUARNIZ. SOTTOCOPPA CONICA H7.8 V - NBR 82/84 ShA | |
| R02280020.V | KIT-CONICAL GROUP GASKET - 10Pcs | KIT-GUARNIZ. SOTTOCOPPA CONICA H7.8 V - NBR- 10Pz | |
| 02290016 | GASKET O RING D9,5 R5 SIL RED | GUARN. OR D 9,5 R5 SILICONE R. | |
| R02290016 | KIT-GASKET O RING D9,5 SIL RED - 30Pcs | KIT-GUARN. OR D 9,5 SILICONE R. - 30Pz | |
| 03000066 | S/S SHOWER 56X5,5X6 WELDED | DOCCIA INOX 56x5,5x 6 SALDATA Aisi304 | |
| R03000066 | KIT-S/S SHOWER 56X5,5X6 WELDED - 5Pcs | KIT-DOCCIA INOX 56x5,5x 6 SALDATA Aisi304 - 5Pz | |
| 03000072 | FILTER ONE COFFEE HIGH 7gr | FILTRO 1 CAFFE' ALTO 7gr. | |
| R03000072 | KIT-FILTER ONE COFFEE HIGH 7gr - 3Pcs | KIT-FILTRO 1 CAFFE' ALTO 7gr. - 3Pz | |
| 03000073 | FILTER TWO COFFEE HIGH 14gr | FILTRO 2 CAFFE' ALTO 14gr. | |
| R03000073 | KIT-FILTER TWO COFFEE HIGH 14gr - 3Pcs | KIT-FILTRO 2 CAFFE' ALTO 14gr. - 3Pz | |
| 03000107 | BLIND FILTER | FILTRO CIECO | |
| R03000107 | KIT-BLIND FILTER - 8Pcs | KIT-FILTRO CIECO - 8Pz | |
| 04100017 | 3WAY SOLENOID DIS BASE 1/8220-230V50/60Hzz F1.5 CE | E.V. NC 3VIE BASETTA SCAR. 1/8220-230V 50/60HzRUBY F | |
| R04100017 | KIT-3WAY SOLENOID DIS BASE 1/8220-230V50/60Hzz - 1P | KIT-E.V. NC 3VIE BASETTA SCAR. 1/8220-230V 50/60Hz- 1Pz | |
| 05000840 | FILTER HOLDER KNOB 2003 BLACK | MANOPOLA PORTAFILTRO 2003 NERO | |
| R05000840 | KIT-FILTER HOLDER KNOB 2003 BLACK-8Pcs | KIT -MANOPOLA PORTAFILTRO 2003 NERO-8Pz | |
| 05000842 | FILTER HOLDER KNOB LOCK 2003 | CHIUSURA MANOPOLA PORTAFILTRO 2003 | |
| R05000842 | KIT-FILTER HOLDER KNOB LOCK - 20Pcs | KIT-CHIUSURA MANOPOLA PORTAFILTRO - 20Pz | |
| 05000844 | BLACK RUBBER COVER FILTER HOLDER KNOB | RIVESTIMENTO GOMMA NERA MANOPOLA PORTAFILTRO | |
| 05080035 | COFFEE TAMPER ABS BLACK | PRESSA CAFFE' ABS NERO | |
| 06200008 | 2WAY OPEN NOZZLE | BECCO DUE VIE OPEN | |
| R06200008 | KIT-2WAY OPEN NOZZLE - 1Pcs | KIT-BECCO DUE VIE OPEN - 1Pz | |
| 07300092 | 1WAY CURVED OPEN NOZZLE | BECCO UNA VIA CURVO OPEN | |
| R07300092 | KIT-1WAY CURVED OPEN NOZZLE - 2Pcs | KIT-BECCO UNA VIA CURVO OPEN - 2Pz | |
| 07300126 | GIGLEUR M8x8 F.1,5 OT-57 +TEA | GIGLER M8x8 F.1,5 OT-57 +TEA | |
| 07300127 | GIGLEUR M8x8 F.2,5 | GIGLER M8x8 F.2,5 | |
| 07300128 | PLUG 1/4 GAS ADD.31.01.89 OT-57 | TAPPO 1/4 GAS AGG.31.01.89 OT-57 | |
| 07300171 | DISPENSING GROUP PLUG OT M20X1,5 | TAPPO OT M20X1,5 GR. EROG. | |
| 07300172 | FITTING 3/8"M-3/8"M INT M8 OT-57 USA | RACCORDO 3/8M-3/8M INT M8 OT-57 USA | |
| R07300172 | KIT-FITTING 3/8"M-3/8"M INT M8 USA - 8Pcs | KIT-RACCORDO 3/8"M-3/8"M INT M8 - 8Pz | |
| 07300183 | GROUP DIFFUSER h=3 OT-57 | PADIGLIONE GRUPPO h=3 OT-57 | |
| R07300183 | KIT-GROUP DIFFUSER h=3 - 2Pcs | KIT-PADIGLIONE GRUPPO h=3 - 2Pz | |
| 07300183.5 | GROUP DIFFUSER h=5 OT-58 | PADIGLIONE GRUPPO h=5 OT-58 | |
| R07300183.5 | KIT-GROUP DIFFUSER h=5 - 2Pcs | KIT-PADIGLIONE GRUPPO h=5 - 2Pz | |
| 07300223 | INFUSION CHAMBER COVER PLUG PREMIER GR | TAPPO CHIUS. CAMERA INFUSIONE GR. PREMIER | |
| 07300226 | GIGLEUR M8x8 F.2 OT-57 + TEA | GIGLER M8x8 F.2,0 OT-57 +TEA | |
| 07300231 | GIGLEUR M8x8 F.1,8 | GIGLER M8x8 F.1,8 | |
| 07300595 | PORTAFILTER KNOB INSERT 2003 AVP ZINC. | INSERTO MANOPOLA PORTAFILTRO 2003 AVP ZINC. | |

| COD. | DESCRIPTION | DESCRIZIONE | VAL. |
|--------------------|---|--|------|
| R07300595 | KIT-PORTAFILTER KNOB INSERT 2003 AVP ZINC.-4Pcs | KIT -INSERTO MANOPOLA PORTAFILTRO 2003 AVP ZINC.-4 | |
| 07300859 | FITTING 3/8M-3/8M GIGLER F.3 OT-57 | RACCORDO 3/8M-3/8M GIGLER F.3 OT-57 | |
| 08000017 | S/S FILTER LOCKING SPRING | MOLLA BLOCCA FILTRO ACC.INOX | |
| R08000017 | KIT-S/S FILTER LOCKING SPRING - 15Pcs | KIT-MOLLA BLOCCA FILTRO ACC.INOX - 15Pz | |
| 08000034 | HOSE CLAMP D12 | FASCETTA STRINGITUBO D12 | |
| 190000110 | 3 WAYS SOLENOID SMALL BASE SCAR.1/8 208-240V 60Hz | E.V. NC 3VIE Basetta SCAR.1/8 208-240V 60Hz F1.5RUBY | |
| 98005021 | COMPLETE SLOPED PORTAFILTER 1WAY N.S. | PORTAFILTRO INCLINATO COMP. 1 VIA N.S. | |
| R98005021 | KIT-COMPLETE SLOPED PORTAFILTER 1WAY N.S. - 1Pcs | KIT-PORTAFILTRO INCLINATO COMP. 1 VIA N.S. - 1Pz | |
| 98005022 | COMPLETE SLOPED PORTAFILTER 2WAY N.S. | PORTAFILTRO INCLINATO COMP. 2 VIE N.S. | |
| R98005022 | KIT-COMPLETE SLOPED PORTAFILTER 2WAY N.S. - 1Pcs | KIT-PORTAFILTRO INCLINATO COMP. 2 VIE N.S. - 1Pz | |
| 98005024 | SLOPED PORTAFILTER BODY + N.S. HANDLE | CORPO PORTAFILTRO INCLINATO + MANOPOLA N.S. | |
| R98005024 | KIT-SLOPED PORTAFILTER BODY + N.S. HANDLE-1Pcs | KIT -CORPO PORTAFILTRO INCLINATO + MANOPOLA N.S.- | |
| 98030202 | SUPERIOR TUBE 3/8 3/8 LOW GR APPIA 2-3GR | TUBO SUP. 3/8 3/8 GR.BASSO APPIA 2-3 GR. | |
| R98030202 | KIT-SUPERIOR TUBE 3/8 3/8 LOW GR - 2Pcs | KIT-TUBO SUP. 3/8 3/8 GR.BASSO - 2Pz | |
| 98030204 | INFERIOR TUBE 3/8 3/8 LOW GR APPIA 2-3GR | TUBO INF. 3/8 3/8 GR.BASSO APPIA 2-3 GR. | |
| R98030204 | KIT-INFERIOR TUBE 3/8 3/8 LOW GR - 2Pcs | KIT-TUBO INF. 3/8 3/8 GR.BASSO - 2Pz | |
| 98030206 | SUPERIOR TUBE 3/8 3/8 RAISED GR APPIA 2-3GR | TUBO SUP. 3/8 3/8 GR. ALTO APPIA 2-3 GR. | |
| R98030206 | KIT-SUPERIOR TUBE 3/8 3/8 RAISED GR - 2Pcs | KIT-TUBO SUP. 3/8 3/8 GR. ALTO - 2Pz | |
| 98030208 | INFERIOR TUBE 3/8 3/8 RAISED GR APPIA 2-3GR | TUBO INF.3/8 3/8 GR.ALTO APPIA 2-3 GR. | |
| R98030208 | KIT-INFERIOR TUBE 3/8 3/8 RAISED GR - 1Pcs | KIT-TUBO INF.3/8 3/8 GR.ALTO - 1Pz | |
| 980400000005000001 | DISPENSING GROUP SET 230V 50/60Hz | ASS. GR. EROG. 230V | |
| 980400000005000002 | DISPENSING GROUP SET 230V KC | ASS. GR. EROG. 230V KC | |
| 980400000005000003 | DISPENSING GROUP SET 115V | ASS. GR. EROG. 115V | |
| 980400000005000004 | DISPENSING GROUP SET ETI 208-240V CSA | ASS. GR. EROG. 208-240V CSA | |
| 980400000005000005 | DISPENSING GROUP SET 115V H=3mm | ASS. GR. EROG. 115V H=3mm | |
| 980400000005000006 | DISPENSING GROUP SET 230V H=3mm | ASS. GR. EROG. 230V H=3mm | |
| 980400000005000007 | DISPENSING GROUP SET 230V FLAT GASKET | ASS. GR. EROG. 230V GUARNIZIONE PIANA | |
| 980400000005000008 | DISPENSING GROUP SET 230V GIGLEUR F.1 | ASS. GR. EROG. 230V GIGLEUR F.1 | |
| 980400000005000009 | DISPENSING GROUP SET 208-240V CSA H=3mm | ASS. GR. EROG. 208-240V CSA H=3mm | |
| 980400000005000010 | GROUP SET DISPENSER 230V H=4mm FLAT GASKET | ASS. GR. EROG. 230V H=4mm GUARNIZIONE PIANA | |
| 980400000005000011 | DISPENSING GROUP SET 230V GIGLEUR F.1 FLAT GASKE | ASS. GR. EROG. 230V GIGLEUR F.1 GUARNIZIONE PIANA | |
| KRIC0002 | 6pc PK LONGLIFE CONICAL GASKET SHEATH MUSICA-AF | CONFEZIONE 6pz. GUARNIZIONE SOTTOCOPPA CONICA L | |

| COD. | DESCRIPTION | DESCRIZIONE | VAL. |
|-----------|---|--|------|
| 00000011 | S/S KNURLED WASHER M4 UNI8842/A | RONDELLA INOX M4 ZIGRINATA UNI8842/A | |
| 00000054 | GALV HIGH NUT M4 | DADO AQ M4 ALTO ZINCATO | |
| 00000063 | GALV WASHER AQ D10X21X2 | RONDELLA AQ D 10x21x2 ZN | |
| 00000124 | GALV WASHER D4 3x16x1.5 | RONDELLA AQ D4.3x16x1.5 ZINC. | |
| 00000133 | S/S CLIP WD12 16-25 C7 W2 | FASCETTA INOX WD12 16-25 C7 W2 | |
| 00000160 | S/S WASHER D4X12 UNI 6593 | RONDELLA INOX D4x12x1 UNI 6593 | |
| 00000175 | S/S CROSS HEAD CAP SCREW M4X10 | VITE INOX M4x10 TC TCR | |
| 00300005 | BRASS NUT 1/8 GAS D4 ADD 22.07.96 CH13 | DADO OT 1/8 GAS AGG.22.07.96 SPESS.4 CH13 | |
| 00300013 | BRASS NUT 3/8 GAS D4 CH20 ADD 22.07.96 | DADO OT 3/8 GAS SPESS.4 CH20 AGG.22.07.96 | |
| 01000010 | S/S FLEXIBLE TUBE 1/4 FF L=320 | TUBO FLESS.INOX 1/4-F.F. L=320 | |
| R01000010 | KIT-S/S FLEXIBLE TUBE 1/4 FF L=320 - 1Pcs | KIT-TUBO FLESS.INOX 1/4-F.F. L=320 - 1Pz | |
| 01000023 | ANTI VACUUM VALVE | VALVOLINA SFIATO | |
| R01000023 | KIT-ANTI VACUUM VALVE - 3Pcs | KIT-VALVOLINA SFIATO - 3Pz | |
| 01000030 | S/S FLEXIBLE TUBE 3/8 FF L=500 | TUBO FLESS INOX 3/8 FF L=500 | |
| 01000072 | ANTI-VIBRATING AD 10X10 M4 MM | ANTIVIBRANTE AD 10x10 M4 MM * KB * | |
| 01000113 | S/S FLEXIBLE TUBE 3/8 90° 3/8 FF L1500 | TUBO FLESS INOX 3/8 A 90 F. - 3/8 F. L=1500 | |
| 01000127 | DIRECT SLEEVE DISCHARGE TUBE D19 L=2m | TUBO SCARICO CON MANICOTTO DIRITTO D.19 L= 2 m | |
| R01000127 | KIT-DIRECT SLEEVE DISCHARGE TUBE D19 L=2m - 2Pcs | KIT-TUBO SCARICO CON MANICOTTO DIRITTO D.19 L= 2 m | |
| 01000190 | VIBRATION DAMPER D15x30 M4 FF | ANTIVIBRANTE CD15x30 M4 FF * KB * | |
| 01300005 | VOLUMETRIC PUMP 100 Lt/h OT-57 | POMPANTE VOLUMETRICO 100 lt/h OT-57 | |
| 01300006 | VOLUMETRIC PUMP 200 Lt/h OT-57 | POMPANTE VOLUMETRICO 200 lt/h OT-57 | |
| 03000202 | CONDENSATION TRAY MASTER | VASCHETTA RACCOGLI CONDENSA AGG. 07.06.97 | |
| 04000010 | CAPACITOR 6 MICRO F | CONDENS. 6microF x 04500033 UL | |
| 04000043 | CAPACITOR 10mF x 04500034 | CONDENS. 10microF x 04500034 UL | |
| R04000043 | KIT-CAPACITOR 10mF - 1Pcs | KIT-CONDENSATORE 10microF - 1Pz | |
| 04000247 | CONNECTION CABLE RAST 2,5/MOLEX L.800MMX TRASD | CAVO COLL.3P RAST 2,5/MOLEX L.800mm x TRASD.PRESS | |
| 04500033 | ELEC ENGINE MASTER/PREMIER 2001 230V 50/60Hz 120W | MOTORE ELETTRICO 230V 50/60Hz 120W | |
| 04500039 | ELEC ENGINE 220/240V 50/60Hz 165W FOR CSA | MOTORE ELETTRICO 220/240V 50/60Hz 165W (x MACCHINI | |
| 05000063 | SAFETY VALVE COVER PA6 | COPRI VALVOLA SICUREZZA PA6 | |
| R05000063 | KIT-SAFETY VALVE COVER PA6 - 8Pcs | KIT-COPRI VALVOLA SICUREZZA PA6 - 8Pz | |
| 05000186 | H3 D6,3/20 NYLON INSERT OSCAR GROUP BLACK | INSERTO NYLON GR. OSCAR h3 D.6,3/20 NERO | |
| 06200125 | 4WAY MANIFOLD 1/4M OT-57 USA | CROCIERA 4 VIE 1/4M OT-57 USA | |
| 07300009 | NUT FITTING 1/4 GAS | DADO RACCORDO 1/4 GAS | |
| 07300017 | FITTING 1/4M 3/8M GAS OT-57 USA | RACCORDO 1/4M 3/8M GAS OT-57 USA | |
| 07300063 | CLOSED TERMINAL D11 | TERMINALE CHIUSO D.11 OT-58 | |
| 07300068 | FITTING L 3/8 M-M CYLIN | RACCORDO L 3/8 M-M CILIN. | |
| 07300099 | FITTING ADAPTER 3/8-1/4 ES. 20 ADD. 29.05.96 | RIDUZIONE 3/8-1/4 ES.20 AGG. 29.05.96 | |
| 07300236 | T FITTING 3/8 M-F-F 466 | RACCORDO A T 3/8 M-F-F | |
| R07300236 | KIT-T FITTING 3/8 M-F-F - 3Pcs | KIT-RACCORDO A T 3/8 M-F-F - 3Pz | |
| 07300249 | FITTING 1/8M L = 12 3/8F | RACCORDO 1/8M L=12 3/8F | |
| 07300382 | STRAIGHT FITTING 1/4 F | RACCORDO DIR. 1/4 F - CALZAM. | |
| 09000016 | SPHERE TAP - NETWORK CONNECTION 3/8 M-F MINI | RUBINET. SFERA ALLACCIO RETE 3/8 M-F MINI | |
| R09000016 | KIT-SPHERE TAP - NETWORK CONNECTION 3/8 M-F MINI | KIT-RUBINET. SFERA ALLACCIO RETE 3/8 M-F MINI- 2Pz | |
| 09100003 | DOUBLE SCALE GAUGE 2,5:15 D.60 | MANOMETRO DOPPIA SCALA 2,5:15 D.60 | |
| R09100003 | KIT-DOUBLE SCALE GAUGE 2,5:15 D.60 - 1Pcs | KIT-MANOMETRO DOPPIA SCALA 2,5:15 D.60 - 1Pz | |

| COD. | DESCRIPTION | DESCRIZIONE | VAL. |
|----------------|--|--|------|
| 09100009 | GAUGE SCALE 0-16 BAR 1/8 D.60 NUOVA SIMONELLI | MANOMETRO SCALA 0-16 BAR 1/8 D.60 NUOVA SIMONELL | |
| R09100009 | KIT-GAUGE SCALE 0-16 BAR 1/8 D.60 -1Pcs | KIT -MANOMETRO SCALA 0-16 BAR 1/8 D.60NUOVA SIMON | |
| 09200018 | PRESSURE TRANSDUCER R1 (W/O WIRE 04000244) 5V D | TRASDUTTORE DI PRESSIONE R1 (SENZA CAVETTO04000 | |
| R09200018 | KIT-PRESSURE TRANSDUCER R1 (W/O WIRE 04000244) - | KIT-TRASDUTTORE DI PRESSIONE (SENZA CAVETTO)- 1Pz | |
| 11740003 | CALIBRATED TEFLON PIPE 6/4 | TUBO TEFLON NSF 6/4 CALIBRATO1 matassa = 50mt | |
| 40000005 | BRASS WASHER 27x17x2 ROUGH | RONDELLA OT 27x17x2 GREZZA | |
| 98013022 | SAFETY VLVE C10 1,8 BAR 3/8" VITON 97/23/CE CAT.IV H1 | VALVOLA SICUREZZA C10 1,8 BAR 3/8" VITON 97/23/CECA1 | |
| R98013022 | KIT-SAFETY VLVE C10 1,8 BAR 3/8" VITON 97/23/CE - 1Pcs | KIT-VALVOLA SICUREZZA C10 1,8 BAR 3/8" VITON- 1Pz | |
| 98030075 | CAPILLARY TUBE 1/8-1/4 0,9X2X400 GAUGE-PUMP | TUBO CAPILLARE 1/8-1/4 0,9x2x400 MANOM.-POMPA | |
| R98030075 | KIT-CAPILLARY TUBE 1/8-1/4 0,9X2X400 GAUGE-PUMP - 2 | KIT-TUBO CAPILLARE 1/8-1/4 0,9x2x400 MANOM.-POMPA- 2 | |
| 98030707 | BOILER PIPE-PRESSURE SENSOR APPIA19 PLUS 2-3GR. | TUBO CALDAIA-SENSORE PRESSIONE APPIA19 PLUS 2-3G | |
| 98030708 | BOILER - PRESSURE GAUGE TUBE APPIA19 2-3GR | TUBO CALDAIA-MANOMETRO APPIA19 2-3GR. | |
| 98030728 | CONNECTION PIPE SAFETY VALVE APPIA19 2-3GR. | TUBO COLL. VALVOLA SICUREZZA APPIA19 2-3GR. | |
| 98170000000011 | PUMP OT 100LT SET + CONNECTORS | ASSIEME POMPANTE OT 100lt + RACCORDI | |
| 98170000000012 | PUMP OT 200LT SET + CONNECTORS | ASSIEME POMPANTE OT 200lt + RACCORDI | |

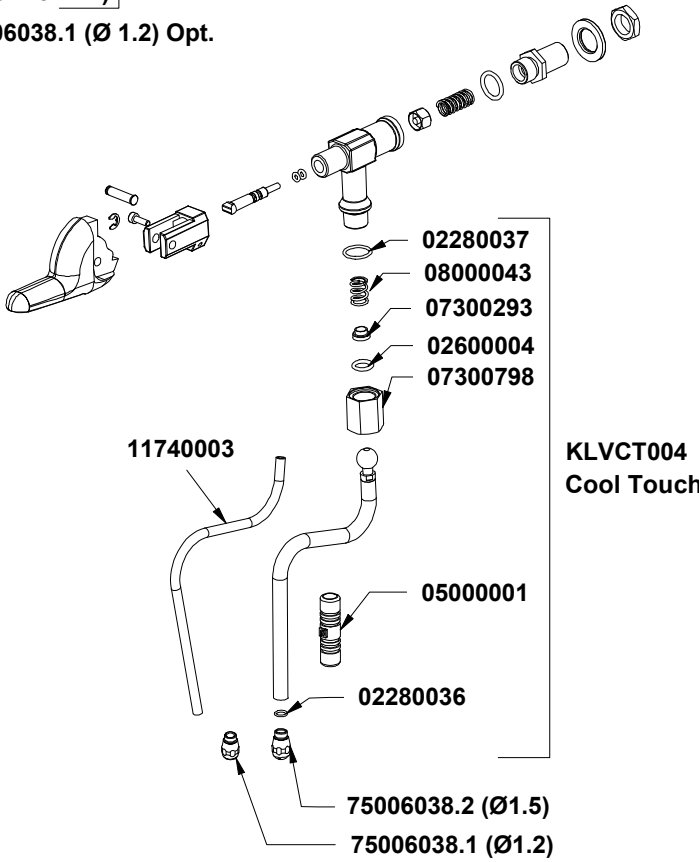
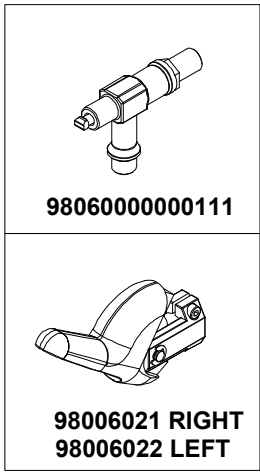
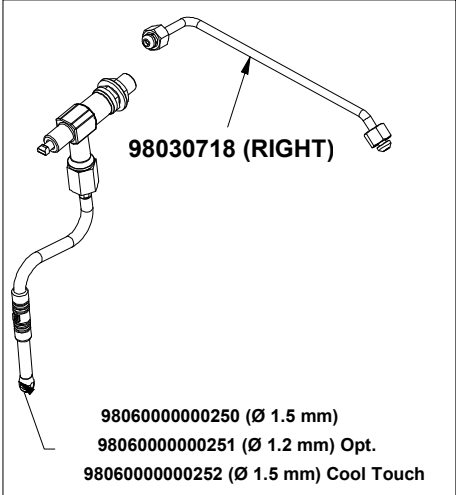
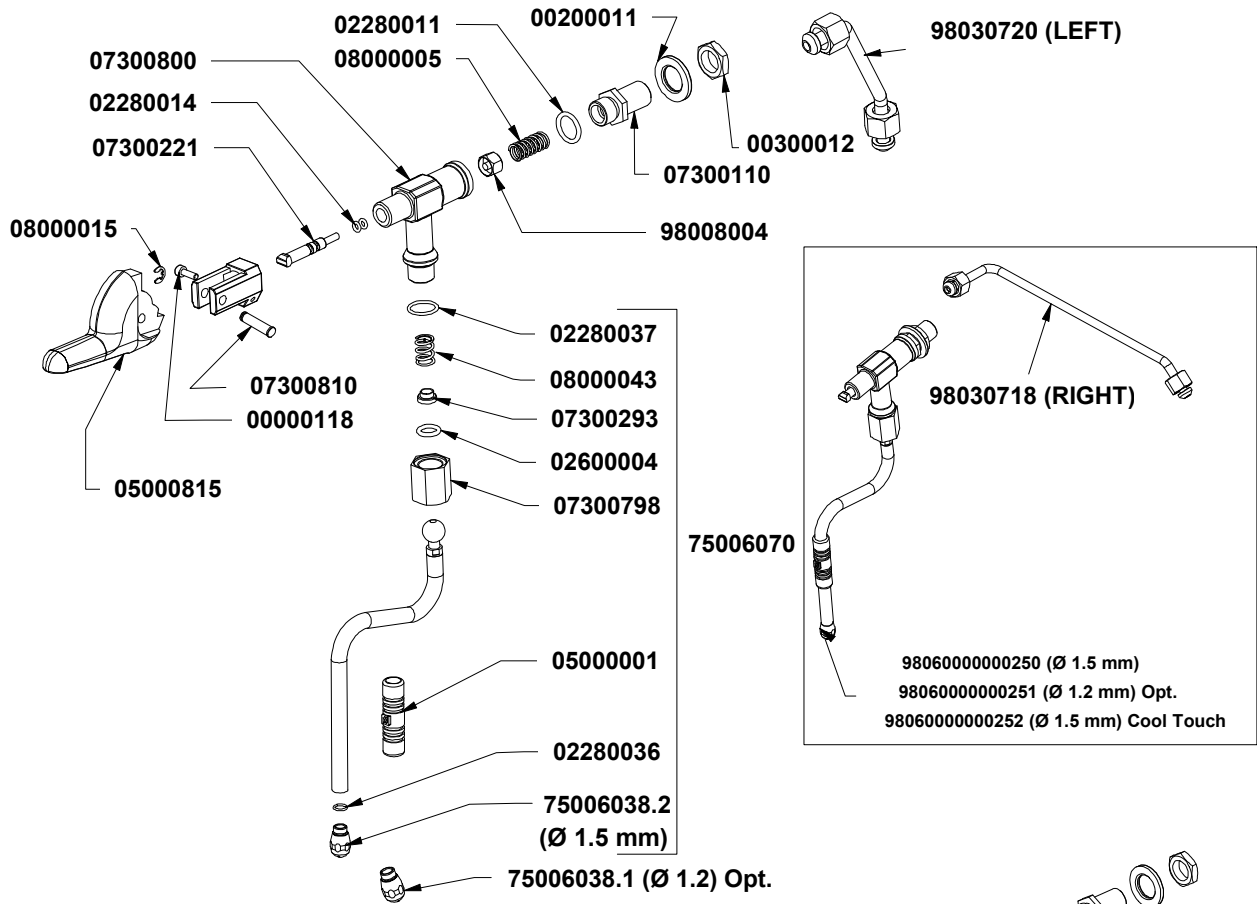

| COD. | DESCRIPTION | DESCRIZIONE | VAL. |
|------------|---|--|------|
| 00000118 | S/SHEx SOCKET CAP SCREW M4x12 5931 | VITE INOX M4x12 TCEI 5931 | |
| 00200011 | GALV WASHER M16 17x30x3 | RONDELLA AQ M16 17x30x3 ZINC | |
| 00300012 | BRASS NUT 3/8 GAS D6 CH22 ADD 22.07.96 | DADO OT 3/8 GAS SPESS.6 CH22 AGG. 22.07.96 | |
| 02280011 | GASKET O RING R11 D19 EP 851 | GUARN. OR R11 D19 EP 851 | |
| R02280011 | KIT-GASKET O RING R11 D19 EP - 25Pcs | KIT-GUARN. OR R11 D19 EP - 25Pz | |
| 02280014 | GASKET GASKET O RING D.7 AN2/OR102 SILICON | GUARN. OR D7 AN2/OR102 SILICON7XL1715 | |
| R02280014 | KIT-GASKET GASKET O RING D.7 AN2/OR102 SILICON - 30 | KIT-GUARN. OR D7 SILICON 7XL1715 - 30Pz | |
| 02280036 | O RING FOR STEAM WAND NOZZLE D6x1.2 EPDM70 500 F | GUARN. OR x BECCO LANCIA VAP. DI 6x1.2 EPDM70(CONF | |
| R02280036 | KIT-O RING FOR STEAM WAND NOZZLE D6x1.2 EPDM - 65 | KIT-GUARN. OR x BECCO LANCIA VAP. D. 6x1.2 EPDM- 65P | |
| 02280037 | GASKET O RING JOINT LOCK 16x2 NBR70 | GUARN. OR CHIUSURA SNODO 16x2 NBR70 | |
| R02280037 | KIT-GASKET O RING JOINT LOCK 16x2 NBR - 45Pcs | KIT-GUARN. OR CHIUSURA SNODO 16x2 NBR - 45Pz | |
| 02600004 | O RING 15,2x10,2x2,5 TEFLON x STEAM WAND SPHERE | GUARN. OR 15,2x10,2x2,5 TEFLONx SFERA LANCIAVAPORI | |
| R02600004 | KIT-O RING 15,2x10,2x2,5 TEFLON x STEAM - 55Pcs | KIT-GUARN. OR 15,2x10,2x2,5 TEFLONx SFERA LANCIA- 55 | |
| 05000001 | RUBBER PROTECTION FOR STEAMWAND D10 | GOMMINO PROTEZIONE LANCIA D.10 | |
| R05000001 | KIT-RUBBER PROTECTION FOR STEAMWAND D10 - 10Pcs | KIT-GOMMINO PROTEZIONE LANCIA D.10 - 10Pz | |
| 05000815 | STEAM LEVER HANDLE AURELIA 2011 | MANOPOLA VAPORE "AURELIA" 2011 | |
| R05000815 | KIT-STEAM LEVER HANDLE - 2Pcs | KIT-MANOPOLA VAPORE - 2Pz | |
| 07300110 | SPRING HOLDER TAP R.V. PR. OT-58 | TAPPO PORTA MOLLA R.V. PR. OT-58 | |
| R07300110 | KIT-SPRING HOLDER TAP R.V. PR. - 6Pcs | KIT-TAPPO PORTA MOLLA R.V. PR. - 6Pz | |
| 07300221 | S/S STEAMTAP ROD | ASTA INOX RUBINETTO VAPORE | |
| R07300221 | KIT-S/S STEAMTAP ROD - 3Pcs | KIT-ASTA INOX RUBINETTO VAPORE - 3Pz | |
| 07300293 | ARTICULATED BUSHING AG.25.06.96 OT-57 | BUSSOLA SNODO AG.25.06.96 OT-57 | |
| R07300293 | KIT-ARTICULATED BUSHING - 15Pcs | KIT-BUSSOLA SNODO - 15Pz | |
| 07300798 | NUT FITTING 3/8 H=26 BRASS-NICKEL ARTICULATED WAI | DADO RACC. 3/8 H=26 LANCIA SNODATA OTTONENICHEL/ | |
| R07300798 | KIT-NUT FITTING 3/8 H=26 BRASS-NICKEL ARTICULATED | KIT-DADO RACC. 3/8 H=26 LANCIA SNODATA OTTONE- 4Pz | |
| 07300800 | STEAM TAP BODY AURELIA II OT-57 | CORPO RUB.VAPORE AURELIA II OT-57 | |
| R07300800 | KIT-STEAM TAP BODY - 1Pcs | KIT-CORPO RUB.VAPORE - 1Pz | |
| 07300810 | STEAM TAP PIN AURELIA IIOT-58 | SPINOTTO RUB.VAPORE AURELIA IIOT-58 | |
| R07300810 | KIT-STEAM TAP PIN - 25Pcs | KIT-SPINOTTO RUB.VAPORE - 25Pz | |
| 08000005 | STEAM TAP SPRING 6 ST 11,5X8,5X25 | MOLLA 6 ST 11,5X8,5X25 RUB.VAPORE | |
| R08000005 | KIT-STEAM TAP SPRING 6 ST 11,5X8,5X25 - 15Pcs | KIT-MOLLA 6 ST 11,5X8,5X25 RUB.VAPORE - 15Pz | |
| 08000015 | S/S SEEGER RING TYPE RS 5 UNI7434 | ANELLO SEEGER TIPO RS 5 INOX UNI7434 | |
| 08000043 | SPRING FOR ARTICULATED WAND D.1.6 D.11.9x16.2 4CO | MOLLA PER LANCIA SNODATA FILO D.1.6 D.11.9x16.2 4SPIL | |
| R08000043 | KIT-SPRING FOR ARTICULATED WAND D.1.6 D.11.9x16.2 | KIT-MOLLA PER LANCIA SNODATA FILO D.1.6 D.11.9x16. - 1 | |
| 11740003 | CALIBRATED TEFLON PIPE 6/4 | TUBO TEFLON NSF 6/4 CALIBRATO1 matassa = 50mt | |
| 75006038.1 | STEAM NOOZLE M8,65X0,75 F1,2 ESAG.12 | BECCO VAPORE M8,65x0,75 F. 1,2 ESAG.12 | |
| 75006038.2 | STEAM NOZZLE M8,65x0,75 F. 1,5 ESAG.12 | BECCO VAPORE M8,65x0,75 F. 1,5 ESAG.12 | |
| 75006070 | SS STEAMWAND KIT NOZZLE 1,5mm HIGH NUT APPIA II | KIT LANCIA VAPORE SNODATA INOX CON BECCO 1,5 EDA | |
| 98006021 | RIGHT STEAM KNOB SET 2004 | ASSIEME MANOPOLA VAPORE 2004 DX | |
| R98006021 | KIT-RIGHT STEAM KNOB SET - 1Pcs | KIT-ASSIEME MANOPOLA VAPORE DX - 1Pz | |
| 98006022 | LEFT STEAM KNOB SET 2004 | ASSIEME MANOPOLA VAPORE 2004 SX | |
| R98006022 | KIT-LEFT STEAM KNOB SET - 1Pcs | KIT-ASSIEME MANOPOLA VAPORE SX - 1Pz | |
| 98008004 | COMPLETE STEAM VALVE PISTON | PISTONCINO CHIUSURA COMPLETO | |
| R98008004 | KIT-COMPLETE STEAM VALVE PISTON - 5Pcs | KIT-PISTONCINO CHIUSURA COMPLETO - 5Pz | |
| 98030718 | RIGHT STEAM WAND PIPE APPIA19 2-3GR. | TUBO LANCIA VAP. DX APPIA19 2-3GR. | |

APPIA 2-3 GR-XT-TIMER
Life. 2-3 GR-XT-TIMER

PARTI RUBINETTI VAPORE
STEAM TAPS PARTS

| COD. | DESCRIPTION | DESCRIZIONE | VAL. |
|-----------------|--|--|------|
| 98030720 | LEFT STEAM WAND PIPE APPIA19 2-3GR. | TUBO LANCIA VAP. SX APPIA19 2-3GR. | |
| 98060000000111 | STEAM TAP SET W/O WAND AURELIA II-APPIA II | ASS. RUBINETTO VAPORE SENZA LANCIA AURELIA II -APP | |
| 980600000000250 | STEAM TAP + STEAMWAND SET W/ HIGH NUT APPIA II | ASS. RUBINETTO VAPORE + LANCIA VAPORE CON DADOA | |
| 980600000000251 | STEAMTAP + STEAMWAND SET W/HIGH NUT APPIAII 1,2N | ASS. RUBINETTO VAPORE + LANCIA VAPORE CON DADOA | |
| 980600000000252 | STEAM TAP SET + COLD STEAM WAND WITH HIGH NUT / | ASS. RUBINETTO VAPORE + LANCIA VAPORE FREDDA CO | |
| KLVCT004 | KIT COOLTOUCH STEAM WAND HIGH NUT APPIA II | KIT LANCIA VAPORE "COOL TOUCH" DADO ALTO APPIA II | |

APPIA *Life.*

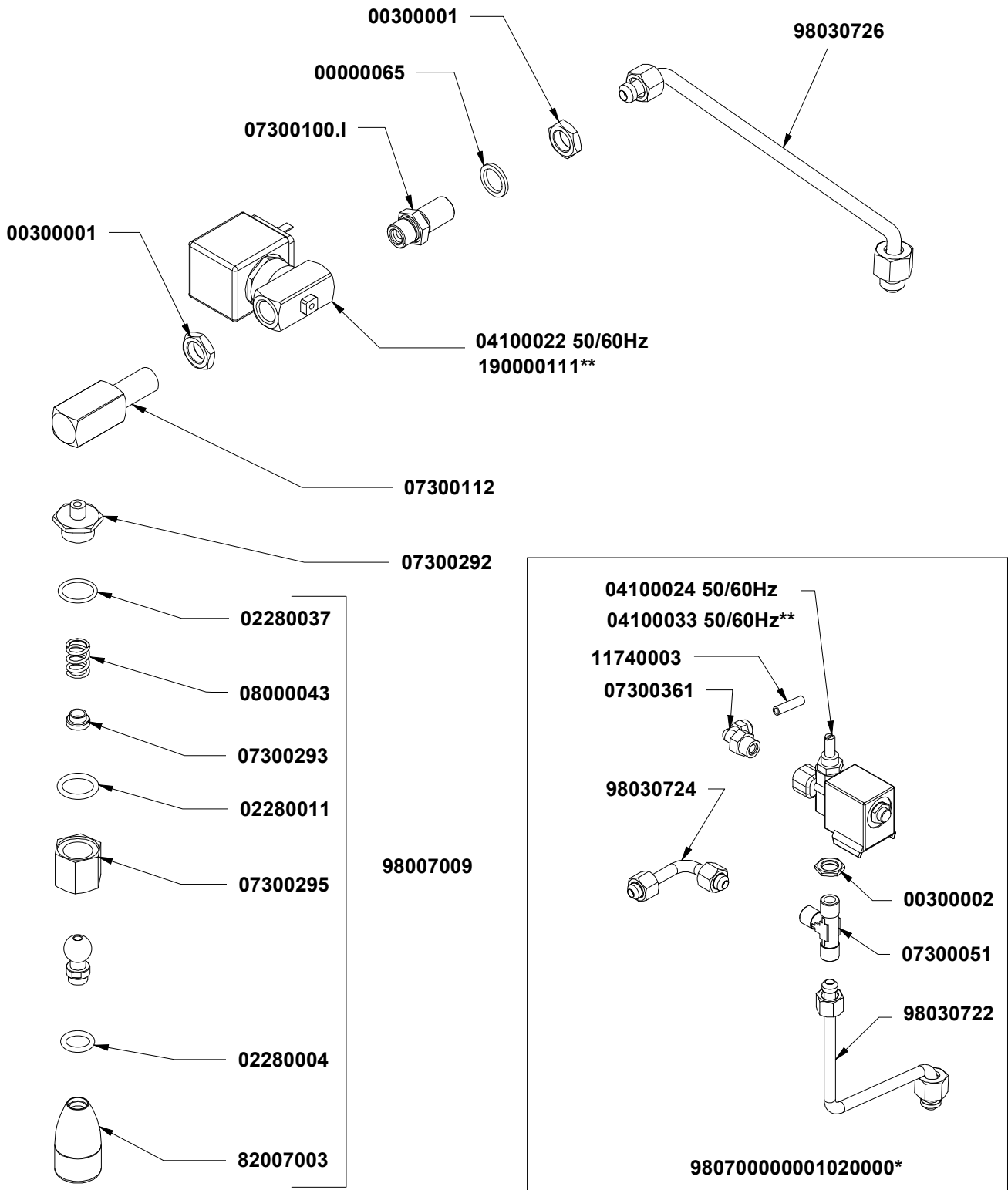

| CODE | DESCRIPTION | DESCRIZIONE |
|----------|--------------------------|-------------------------|
| 04001526 | SUPPL. WIR. SOL.VALVE-MI | SUPPL. CABL. E.V. MISC. |

*Specificare versione
Specify version
**Mercato Nord America
North America Market

| COD. | DESCRIPTION | DESCRIZIONE | VAL. |
|-------------------|--|--|------|
| 00000065 | BRASS WASHER 1/4 | RONDELLA OT 1/4 AGG.07.03.86 | |
| 00300001 | BRASS NUT 1/4 GAS D5 CH18 | DADO OT 1/4 GAS SPESS.5 CH18 *AGG. 22.07.96 | |
| 00300002 | BRASS NUT 1/4 D3 CH18 | DADO OT 1/4 SPESS.3 CH18 AGG. 22.07.96 | |
| R00300002 | KIT-BRASS NUT 1/4 D3 - 15Pcs | KIT-DADO OT 1/4 SPESS.3 - 15Pz | |
| 02280004 | GASKET O RING 115 D17 EP 856 x SWIVEL STEAM PIPE | GUARN. OR 115 D.17 EP856 SNODO LANCIA | |
| R02280004 | KIT-GASKET O RING 115 D17 EP 856 x STEAM PIPE - 55Pcs | KIT-GUARN. OR 115 D.17 EP856 SNODO LANCIA - 55Pz | |
| 02280011 | GASKET O RING R11 D19 EP 851 | GUARN. OR R11 D19 EP 851 | |
| R02280011 | KIT-GASKET O RING R11 D19 EP - 25Pcs | KIT-GUARN. OR R11 D19 EP - 25Pz | |
| 02280037 | GASKET O RING JOINT LOCK 16x2 NBR70 | GUARN. OR CHIUSURA SNODO 16x2 NBR70 | |
| R02280037 | KIT-GASKET O RING JOINT LOCK 16x2 NBR - 45Pcs | KIT-GUARN. OR CHIUSURA SNODO 16x2 NBR - 45Pz | |
| 04001526 | CABLE SUPPLEMENTO SOLENOID H.WATER MIXER APPIA | SUPPL. CABLAGGIO E.V. MISCELATORE A.CALDA APPIASE | |
| 04100022 | 2WAY SOLENOID 1/4-1/4 220-230V50/60Hz F3 CE TH1xM4 | E.V. NC 2VIE 1/4-1/4 220-230V 50/60Hz RUBINO F3 CE PIEDI | |
| R04100022 | KIT-2WAY SOLENOID 1/4-1/4 220-230V50/60Hz F3 CE - 1Pcs | KIT-E.V. NC 2VIE 1/4-1/4 220-230V 50/60Hz RUBINO- 1Pz | |
| 04100024 | 3WAY SOLENOID 1/4 REGUL 90° 230V50/60Hz F3 CE | E.V. NC 2VIE 1/4 REGOLAT. 90° 230V 50/60Hz F.3 CE | |
| R04100024 | KIT-3WAY SOLENOID 1/4 REGUL 90° 230V50/60Hz F3 CE - 1Pcs | KIT-E.V. NC 2VIE 1/4 REGOLAT. 90° 230V 50/60Hz F.3- 1Pz | |
| 04100033 | 2WAY SOLENOID 1/4 REGUL 90° 230/240V 50/60Hz F3 UL | E.V. NC 2VIE 1/4 REGOLAT. 90° 230/240V 50/60Hz F3UL CAI | |
| 07300051 | FITTING T 1/4 M-M-M CYLIN. | RACCORDO T 1/4 M-M-M CILIN. | |
| 07300100.1 | DISCHARGE ATTACHMENT 1/4 1/4 INOX AISI316 | ATTACCO SCAR. 1/4-1/4 INOX Aisi316 | |
| 07300112 | WATER TAP CONNECTION OT-57 USA | ATTACCO RUB. ACQUA OT-57 USA | |
| 07300292 | TAP ATTACHMENT FOR ARTICULATED S/S STEAMWAND | ATTACCO RUBINETTO PER LANCIA VAPORE SNODATA IN | |
| 07300293 | ARTICULATED BUSHING AG.25.06.96 OT-57 | BUSSOLA SNODO AG.25.06.96 OT-57 | |
| R07300293 | KIT-ARTICULATED BUSHING - 15Pcs | KIT-BUSSOLA SNODO - 15Pz | |
| 07300295 | NUT FITTING 3/8 H=21 BRASS-NICKEL ARTICULATED WAI | DADO RACC. 3/8 H=21 LANCIA SNODATA OTTONENICHEL/ | |
| R07300295 | KIT-NUT FITTING 3/8 H=21 BRASS-NICKEL ARTICULATED | KIT-DADO RACC. 3/8 H=21 LANCIA SNODATA - 6Pz | |
| 07300361 | FITTING L GIR 1/4 M-FITTING 6 VITON 346 A NICKEL-PLAT | RACCORDO L GIR 1/4 M-CALZAM.6 VITON 346 ANICHELATI | |
| 08000043 | SPRING FOR ARTICULATED WAND D.1.6 D.11.9x16.2 4CO | MOLLA PER LANCIA SNODATA FILO D.1.6 D.11.9x16.2 4SPIL | |
| R08000043 | KIT-SPRING FOR ARTICULATED WAND D.1.6 D.11.9x16.2 | KIT-MOLLA PER LANCIA SNODATA FILO D.1.6 D.11.9x16.2 - 1 | |
| 11740003 | CALIBRATED TEFLON PIPE 6/4 | TUBO TEFLON NSF 6/4 CALIBRATO1 matassa = 50mt | |
| 190000111 | 2 WAYS SOLENOID 1/4-1/4 208-240V 60Hz RUBY F3 UL NSF | E.V. NC 2VIE 1/4-1/4 208-240V 60Hz RUBY F3 UL NSF 121K- | |
| 82007003 | HOTWATER DIFFUSER D23,5 F1/8 WITH PLASTIC AERATC | ROMPIGETTO ACQUA CALDA D.23,5 F 1/8" CON AERATORI | |
| 98007009 | S/S HOTWATER WAND KIT L70 W/ DIFFUSER | KIT LANCIA ACQUA C. INOX L=70 COMP. DI ROMPIGETTO8 | |
| R98007009 | KIT-S/S HOTWATER WAND KIT L70 W/ DIFFUSER - 1Pcs | KIT-KIT LANCIA ACQUA C. INOX L=70 COMP. DI ROMPIGE- | |
| 98030722 | BOILER PIPE - E.V. BLENDER APPIA19 2-3GR. | TUBO CALDAIA - EV MISCELATORE APPIA19 2-3GR. | |
| 98030724 | PIPE E.V. BLENDER - HOT WATER WAND APPIA19 2-3GR. | TUBO EV MISCELAT.-LANCIA ACQUA CALDA APPIA192-3GR | |
| 98030726 | BOILER PIPE -HOT WATER E.V. APPIA19 2-3GR. | TUBO CALDAIA - EV ACQUA CALDA APPIA19 2-3GR. | |
| 98070000001020001 | HOT WATER SET MIXER APPIA19 2-3GR CE | ASS. MISCELATORE A.CALDA 2-3GR. CE | |
| 98070000001020002 | HOT WATER SET MIXER APPIA19 2-3GR KC | ASS. MISCELATORE A.CALDA 2-3GR. KETI - KC | |
| 98070000001020003 | HOT WATER SET MIXER APPIA19 2-3GR CSA | ASS. MISCELATORE A.CALDA 2-3GR. CSA | |

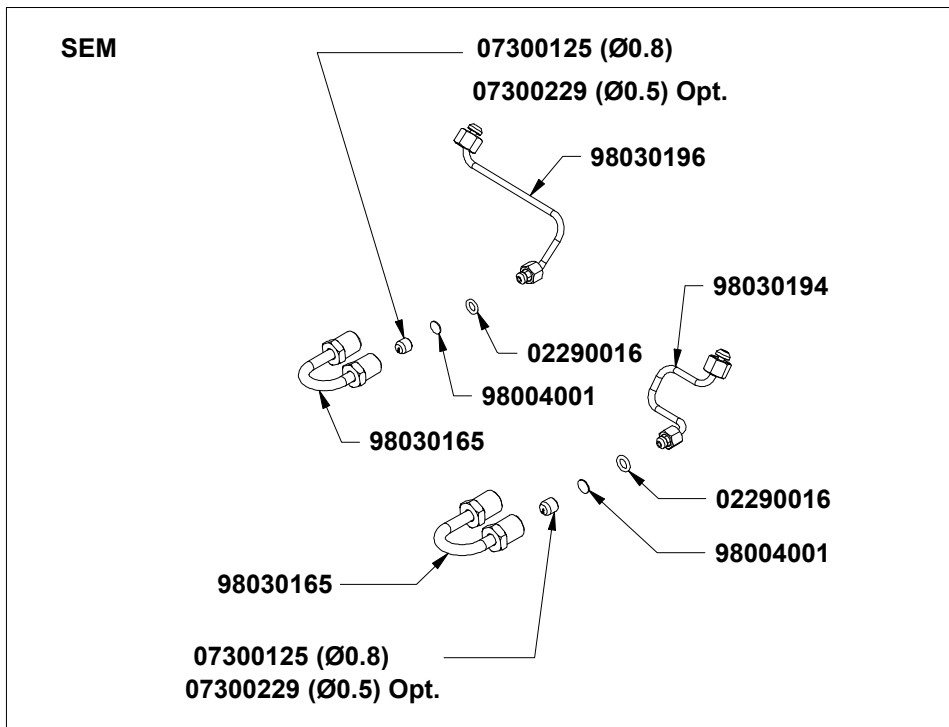
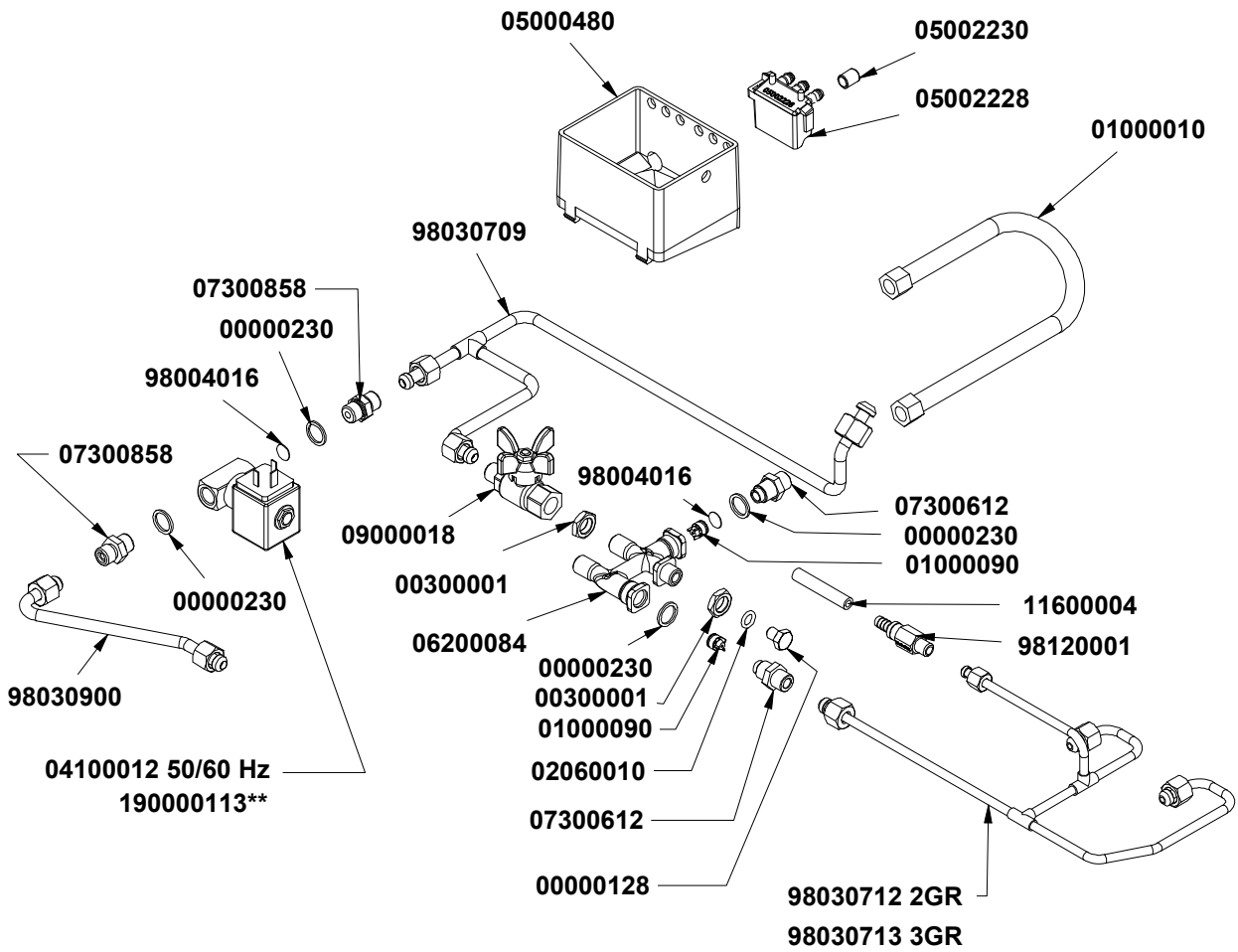

**North America Market
 Mercato Nord America

| COD. | DESCRIPTION | DESCRIZIONE | VAL. |
|-----------|---|--|------|
| 00000128 | S/S HEX CAP SCREW M8x10 THREADED | VITE INOX M8x10 TE TUTTO FIL. | |
| 00000230 | COPPER WASHER SEAL 14X18X1.5 | RONDELLA GUARNIZIONE RAME RICOTTO 14x18x1.5 | |
| 00300001 | BRASS NUT 1/4 GAS D5 CH18 | DADO OT 1/4 GAS SPESS.5 CH18 *AGG. 22.07.96 | |
| 01000010 | S/S FLEXIBLE TUBE 1/4 FF L=320 | TUBO FLESS.INOX 1/4-F.F. L=320 | |
| R01000010 | KIT-S/S FLEXIBLE TUBE 1/4 FF L=320 - 1Pcs | KIT-TUBO FLESS.INOX 1/4-F.F. L=320 - 1Pz | |
| 01000090 | RETAINING VALVE D10 | VALVOLINA DI RITEGNO D.10 | |
| R01000090 | KIT-RETAINING VALVE D10 - 6Pcs | KIT-VALVOLINA DI RITEGNO D.10 - 6Pz | |
| 02060010 | COPPER O RING 8.3x13x1.9 ND8 | OR RAME 8,3x13x1,9 DN8 | |
| 02290016 | GASKET O RING D9,5 R5 SIL RED | GUARN. OR D 9,5 R5 SILICONE R. | |
| R02290016 | KIT-GASKET O RING D9,5 SIL RED - 30Pcs | KIT-GUARN. OR D 9,5 SILICONE R. - 30Pz | |
| 04100012 | 2WAY SOLENOID 1/4-1/4 220-230V50/60hz F1.5 UL TH2xM | E.V. NC 2VIE 1/4-1/4 220-230V 50/60HZ VITON F1.5CE PIEDI | |
| R04100012 | KIT-2WAY SOLENOID 1/8-1/8 1/8 240V50/60hz F3 - 1Pcs | KIT-E.V. NC 2VIE 1/4-1/4 220-230V 50/60HZ VITON- 1Pz | |
| 05000480 | DRAIN TRAY VA358 | VASCHETTA SCARICO VA358 | |
| 05002228 | DISCHARGE MANIFOLD DISPENSING GROUP | COLLETORE SCARICO GRUPPI EROG | |
| 05002230 | DRAIN RUBBER PLUG D8 x 05002228 | TAPPO GOMMA SCARICO D.8 x 05002228 | |
| 06200084 | 5WAY MANIFOLD AURELIA OT-57 USA | CROCIERA 5 VIE AURELIA OT-57 USA | |
| R06200084 | KIT-5WAY MANIFOLD USA - 1Pcs | KIT-CROCIERA 5 VIE - 1Pz | |
| 07300125 | GIGLEUR M8x8 F.0,8 OT-57 +TEA | GIGLER M8x8 F.0,8 OT-57 +TEA | |
| R07300125 | KIT-GIGLEUR M8x8 F.0,8 +TEA - 15Pcs | KIT-GIGLER M8x8 F.0,8 - 15Pz | |
| 07300229 | GIGLEUR M8X8 F.0,5 OT-57 + TEA | GIGLER M8x8 F.0,5 OT-57 +TEA | |
| R07300229 | KIT-GIGLEUR M8X8 F.0,5 + TEA - 15Pcs | KIT-GIGLER M8x8 F.0,5 - 15Pz | |
| 07300612 | FITTING 1/4 1/4 GAS WITH ORING + RETURN VALVE LOCK | RACCORDO 1/4 1/4 GAS CON OR + BLOCCA VALVOLINARI | |
| 07300858 | FITTING 1/4M-1/4M OT-57 USA | RACCORDO 1/4M-1/4M OT-57 USA | |
| R07300858 | KIT-FITTING 1/4M-1/4M - 15Pcs | KIT-RACCORDO 1/4M-1/4M - 15Pz | |
| 09000018 | DISPENSING SPHERE TAP 1/4 M-F "BUTTERFLY" | RUBINET. SFERA DISTRIBUTORE 1/4 M-F A FARFALLA | |
| 11600004 | SILICONE PIPE 5x9 60Sh PEROX WHITE SEMITRASPAREN | TUBO SILICONE 5x9 70Sh PEROX TRASPARENTE(1mt=50gr) | |
| 190000113 | 2 WAYS SOLENOID 1/4-1/4 208-240V 60Hz FKM F1.5 UL NSF | E.V. NC 2VIE 1/4-1/4 208-240V 60Hz FKM F1,5 UL NSF | |
| 98004001 | S/S FILTER D8 | FILTRO INOX DIAM. 8 | |
| 98004016 | S/S FILTER D12 | FILTRO INOX DIAM. 12 | |
| R98004016 | KIT-S/S FILTER D12 - 25Pcs | KIT-FILTRO INOX DIAM. 12 - 25Pz | |
| 98030165 | TUBE 1/4 1/4 SEMI-AUTO MODIFY APPIA 1-2-3GR | TUBO 1/4 1/4 MODIFICA SEMIAUT APPIA 1-2-3 GR. | |
| 98030194 | TUBE 3/8 1/4 RIGHT EXCHANGER APPIA S-V 2-3GR | TUBO 3/8 1/4 COLL. SCAMB. DX APPIA S-V 2-3 GR. | |
| R98030194 | KIT-TUBE 3/8 1/4 RIGHT EXCHANGER - 2Pcs | KIT-TUBO 3/8 1/4 COLL. SCAMB. DX - 2Pz | |
| 98030196 | TUBE 3/8 1/4 LEFT EXCHANGER APPIA S-V 2-3GR | TUBO 3/8 1/4 COLL. SCAMB. SX APPIA S-V 2-3 GR. | |
| 98030709 | CENTRAL CHARGE BOILER PIPE APPIA19 2-3GR. | TUBO CARICO CENTRALE CALDAIA APPIA19 2-3GR. | |
| 98030712 | MANIFOLD 2GR APPIA19 | CROCIERA 2GR. APPIA19 | |
| 98030713 | MANIFOLD 3GR APPIA19 | CROCIERA 3GR. APPIA19 | |
| 98030900 | VALVE LEVEL - MANIFOLD TUBE VA358 | TUBO E.V. LIVELLO-CROCIERA VA358 | |
| 98120001 | NEPLAX VITON 16,5 BAR VALVE 1/8 HOSE CLAMP | VALVOLA NEPLAX VITON 16,5 BAR 1/8 - PORTAGOMMA | |
| R98120001 | KIT-NEPLAX VITON 16,5 BAR VALVE 1/8 HOSE CLAMP - 2F | KIT-VALVOLA NEPLAX VITON 16,5 BAR 1/8 - PORTAGOMMA | |

LEFT

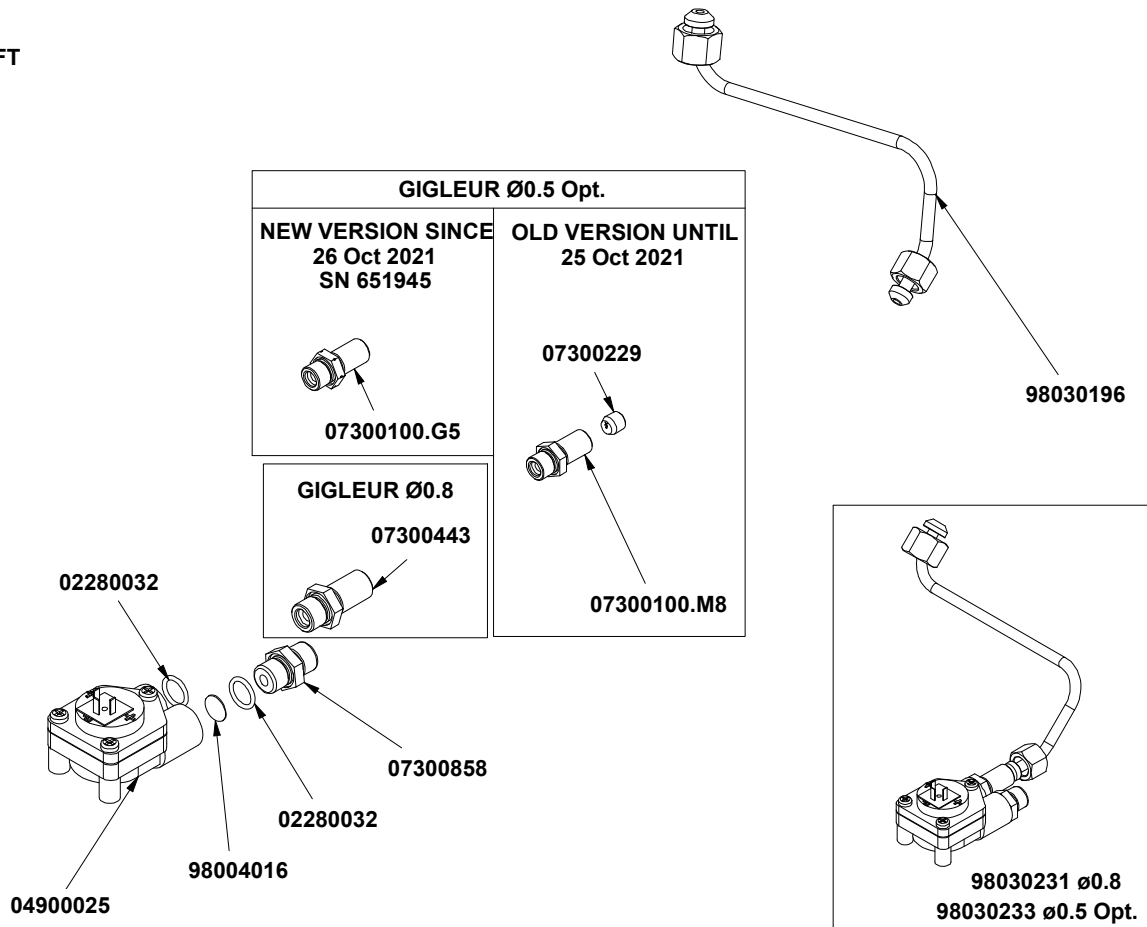

RIGHT

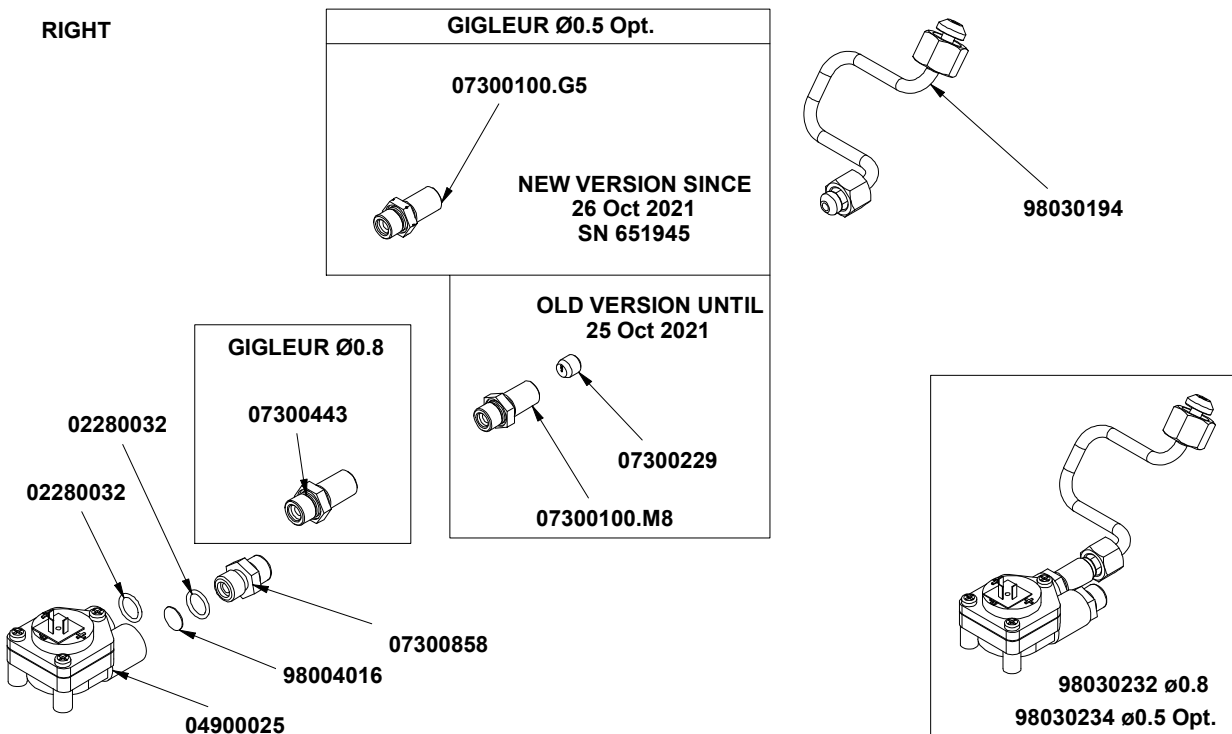

T.07 - bis

| COD. | DESCRIPTION | DESCRIZIONE | VAL. |
|--------------|---|--|------|
| 02280032 | GASKET O RING 114 D15 EP 851 | GUARN. OR 114 D.15 EP 851 | |
| R02280032 | KIT-GASKET O RING 114 D15 EP - 25Pcs | KIT-GUARN. OR 114 D.15 EP - 25Pz | |
| 04900025 | BRASS FLOWMETER 1/4-1/4 GAS-ATT. HEAD 2,8x0,5 F 1,2 | DOSATORE VOLUMETRICO OTT. 1/4-1/4 GAS-ATT. TEST.2, | |
| 07300100.G5 | CONNECTION 1/4M-1/4M GIGLER F.0,5 OT-57 USA | ATTACCO SCAR. 1/4M-1/4M GIGLER F.0,5 OT-57 USA | |
| 07300100.M8 | DISCHARGE ATTACHMENT 1/4 1/4 + INT M8 OT-57 USA | ATTACCO SCAR. 1/4-1/4 + INT M8 OT-57 USA | |
| R07300100.M8 | KIT-DISCHARGE ATTACHMENT 1/4 1/4 + INT - 8Pcs | KIT-ATTACCO SCAR. 1/4-1/4 + INT M8 - 8Pz | |
| 07300229 | GIGLEUR M8X8 F.0,5 OT-57 + TEA | GIGLER M8x8 F.0,5 OT-57 +TEA | |
| R07300229 | KIT-GIGLEUR M8X8 F.0,5 + TEA - 15Pcs | KIT-GIGLER M8x8 F.0,5 - 15Pz | |
| 07300443 | FITTING 1/4M 1/4M GIGLER F.0,8 OT-57 USA | RACCORDO 1/4M 1/4M GIGLER F.0,8 OT-57 USA | |
| 07300858 | FITTING 1/4M-1/4M OT-57 USA | RACCORDO 1/4M-1/4M OT-57 USA | |
| R07300858 | KIT-FITTING 1/4M-1/4M - 15Pcs | KIT-RACCORDO 1/4M-1/4M - 15Pz | |
| 98004016 | S/S FILTER D12 | FILTRO INOX DIAM. 12 | |
| R98004016 | KIT-S/S FILTER D12 - 25Pcs | KIT-FILTRO INOX DIAM. 12 - 25Pz | |
| 98030194 | TUBE 3/8 1/4 RIGHT EXCHANGER APPIA S-V 2-3GR | TUBO 3/8 1/4 COLL. SCAMB. DX APPIA S-V 2-3 GR. | |
| R98030194 | KIT-TUBE 3/8 1/4 RIGHT EXCHANGER - 2Pcs | KIT-TUBO 3/8 1/4 COLL. SCAMB. DX - 2Pz | |
| 98030196 | TUBE 3/8 1/4 LEFT EXCHANGER APPIA S-V 2-3GR | TUBO 3/8 1/4 COLL. SCAMB. SX APPIA S-V 2-3 GR. | |
| 98030231 | LEFT FLOWMETER SET APPIA 2-3GR GIGLER F.0,8 PLAS | ASSIEME DOSATORE SX APPIA 2-3GR. GIGLER F.0,8TEST/ | |
| 98030232 | RIGHT FLOWMETER SET APPIA 2-3GR GIGLER F.0,8 PLAS | ASSIEME DOSATORE DX APPIA 2-3GR. GIGLER F.0,8TEST/ | |
| 98030233 | LEFT FLOWMETER SET APPIA 2-3GR GIGLER F.0,5 | ASSIEME DOSATORE SX APPIA 2-3GR. GIGLER F.0,5TEST/ | |
| 98030234 | RIGHT FLOWMETER SET APPIA 2-3GR GIGLER F.0,5 | ASSIEME DOSATORE DX APPIA 2-3GR. GIGLER F.0,5TEST/ | |

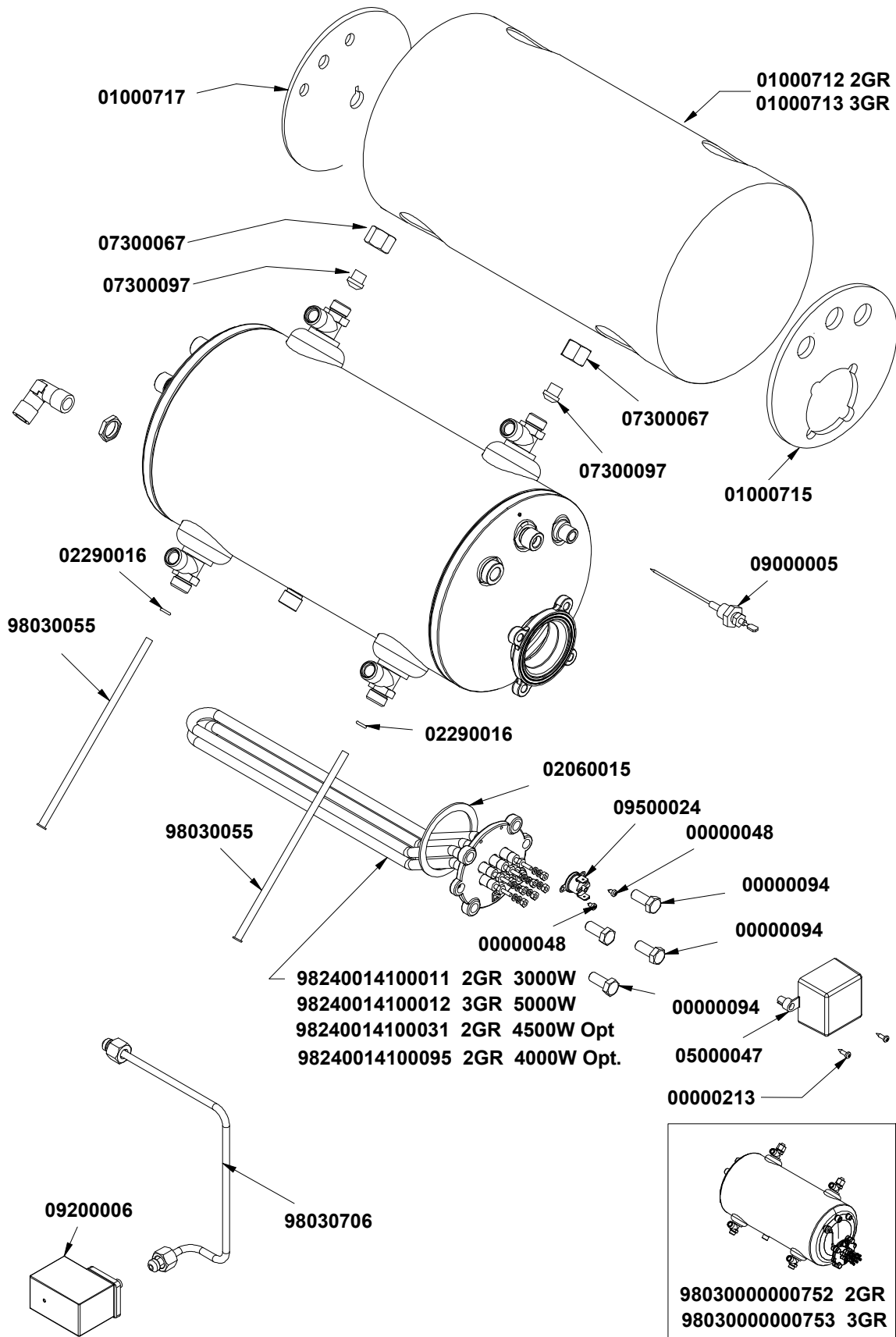

| COD. | DESCRIPTION | DESCRIZIONE | VAL. |
|-----------------|--|--|------|
| 00000048 | SELF-TAPPING SCREW 2.9x4.5 TC/T.CR. | VITE AUTOF 2,9x4,5 TC/T.CR. | |
| 00000094 | S/S HEX CAP SCREW M8x20 5739 | VITE INOX M8x20 TE 5739 | |
| 00000213 | GALV SELF-TAPPING SCREW 4,2x16 TC T.CR. | VITE AUTOF 4,2x16 TC T.CR. ZIN | |
| 01000713 | BOILER INSULATION 3GR | ISOLANTE CALDAIA APPIA LIFE 3GR MELAMMINA | |
| 01000712 | BOILER INSULATION 2GR | ISOLANTE CALDAIA APPIA LIFE 2GR MELAMMINA | |
| 01000715 | RIGHT BOILER INSULATION 2-3GR | ISOLANTE D.184 DX CALDAIA APPIA LIFE 2-3GR MELAMMINA | |
| 01000717 | LEFT BOILER INSULATION 2-3GR | ISOLANTE D.184 SX CALDAIA APPIA LIFE 2-3GR MELAMMINA | |
| 02060015 | GASKET FOR HEATING ELEMENT 067x054x2 | GUARNIZIONE PTFE 067x054x2 | |
| R02060015 | KIT-GASKET FOR HEATING ELEMENT 067x054x2 - 8Pcs | KIT-GUARNIZIONE PTFE 067x054x2 - 8Pz | |
| 02290016 | GASKET O RING D9,5 R5 SIL RED | GUARN. OR D 9,5 R5 SILICONE R. | |
| R02290016 | KIT-GASKET O RING D9,5 SIL RED - 30Pcs | KIT-GUARN. OR D 9,5 SILICONE R. - 30Pz | |
| 05000047 | SQUARE RESISTANCE COVER V0 | COPRI RESISTENZA QUADRATA V0 | |
| R05000047 | KIT-SQUARE RESISTANCE COVER V0 - 6Pcs | KIT-COPRI RESISTENZA QUADRATA - 6Pz | |
| 07300067 | NUT FITTING 3/8 GAS D11 ADD. 15.11.84 OT-58 | DADO RACCORDO 3/8 GAS D11 AGG. 15.11.84 OT-58 | |
| 07300097 | CLOSED TERMINAL D14 OT-57 | TERMINALE CHIUSO D 14 OT-57 | |
| 09000005 | COMPLETE AUTOLEVEL PROBE L=130 | SONDA AUTOLIVELLO COMP. L=130 | |
| R09000005 | KIT-COMPLETE AUTOLEVEL PROBE L=130 - 1Pcs | KIT-SONDA AUTOLIVELLO COMP. L=130 - 1Pz | |
| 09200006 | MACHINE PRESSO GAUGE CE/UL TRIF. 30A 400V 0,5-1,4E | PRESSOSTATO MACCHINA CE/UL TRIF. 30A 400V0,5-1,4BA | |
| R09200006 | KIT-MACHINE PRESSO GAUGE CE/UL TRIF. 30A 400V - 1P | KIT-PRESSOSTATO MACCHINA CE/UL TRIF. 30A 400V- 1Pz | |
| 09500024 | MANUAL THERMOSTAT 135°C TRIP FREE GREEN DRIPPIII | TERMOSTATO R.MAN. 135°C TRIP FREE GOCCIOLATURAV | |
| 9803000000752 | COMPLETE BOILER SET 2GR APPIA19 | ASSIEME CALDAIA COMP.2GR APPIA19 | |
| 9803000000753 | COMPLETE BOILER SET 3GR APPIA19 | ASSIEME CALDAIA COMP.3GR APPIA19 | |
| 98030055 | INTERNAL TEFLON TUBE EXCHANGER D6x180mm | TUBO TEFLON INT. SCAMBIATORE D.6 x 180 mm. | |
| R98030055 | KIT-INTERNAL TEFLON TUBE EXCHANGER D6x180mm - 3 | KIT-TUBO TEFLON INT. SCAMBIATORE D.6 x 180 mm.- 3Pz | |
| 98030706 | BOILER PIPE-PRESSURE GAUGE APPIA19 2-3GR. | TUBO CALDAIA-PRESSOSTATO APPIA19 2-3GR. | |
| 98240014100011 | HEATING ELEMENT W/ NUTS 3000W | RESISTENZA COMPLETA DI DADI 3000W | |
| R98240014100011 | KIT-HEATING ELEMENT W/ NUTS 3000W -1Pcs | KIT -RESISTENZA COMPLETA DI DADI 3000W-1PZ | |
| 98240014100012 | HEATING ELEMENT W/ NUTS 5000W | RESISTENZA COMPLETA DI DADI 5000W | |
| R98240014100012 | KIT-HEATING ELEMENT W/ NUTS 5000W - 1Pcs | KIT-RESISTENZA COMPLETA DI DADI 5000W - 1Pz | |
| 98240014100031 | HEATING ELEMENT W/ NUTS 4500W | RESISTENZA COMPLETA DI DADI 4500W | |
| R98240014100031 | KIT-HEATING ELEMENT W/ NUTS 4500W - 1Pcs | KIT-RESISTENZA COMPLETA DI DADI 4500W - 1Pz | |
| 98240014100095 | HEATING ELEMENT W/ NUTS 4000W 230/380V | RESISTENZA COMPLETA DI DADI 4000W 230/380 | |

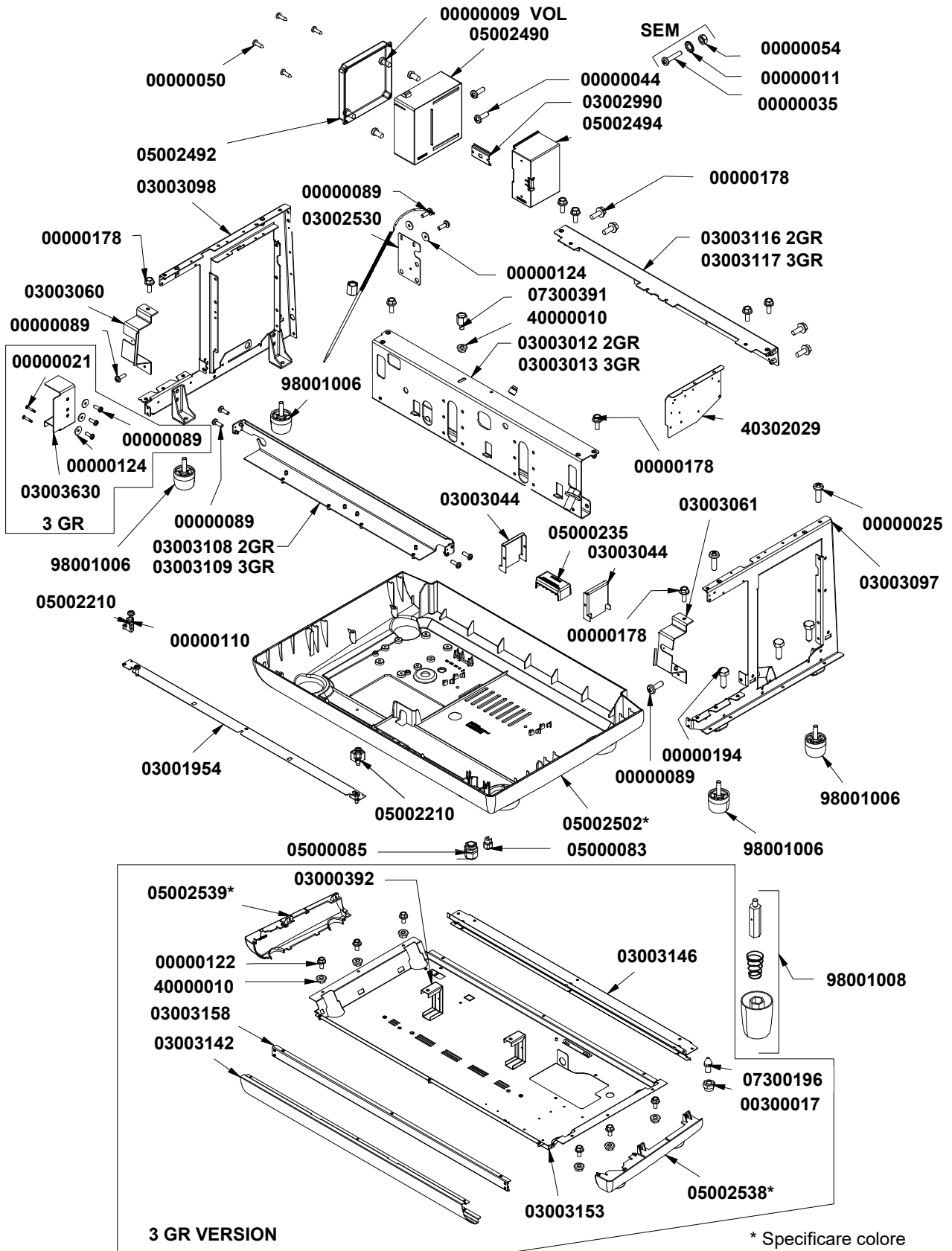

* Specificare colore
 Specify color

| COD. | DESCRIPTION | DESCRIZIONE | VAL. |
|--------------|--|---|------|
| 00000009 | GALV SELF-TAPPING SCREW 3,5x6,5 MUSTAD | VITE AUTOF 3,5x8 Z.B. HILO TC TCR | |
| 00000011 | S/S KNURLED WASHER M4 UNI8842/A | RONDELLA INOX M4 ZIGRINATA UNI8842/A | |
| 00000021 | GALV CROSS HEAD CAP SCREW M4x25 | VITE AQ M4x25 TC T.CR. ZINC. TAPT AUTOFORMANTE | |
| 00000025 | GALV CROSS HEAD CAP SCREW AQ M6x20 | VITE AQ M6x20 TC T.CR. ZINC | |
| 00000035 | GALV CROSS HEAD/CAP SCREW M4x20 | VITE AQ M4x20 TC T.CR. ZINC | |
| 00000044 | GALV CROSS HEAD/CAP SCREW M4x10 | VITE AQ M4x10 TC T.CR. ZINC | |
| 00000050 | CROSS HEAD/CAP SELF-TAPPING CHIPBOARD SCREW 3 | VITE AUTOF 3,5x12 TC/T.CR. TRUCIOLARE | |
| 00000054 | GALV HIGH NUT M4 | DADO AQ M4 ALTO ZINCATO | |
| 00000089 | S/S CROSSHEAD CAP SCREW M4x12 DIN7985 | VITE INOX M4x12 TC TCR DIN7985 | |
| 00000110 | S/S CROSS HEAD CAP SCREW M4x20 7985 | VITE INOX M4x20 TC TCR 7985 | |
| 00000122 | WHITE GALV FLANGED KNURLED HEX CAP SCREW 8.8 M | VITE AQ 8.8 M6x12 TE FLANG. ZIGR. ZINC. BIANCO | |
| 00000124 | GALV WASHER D4 3x16x1.5 | RONDELLA AQ D4.3x16x1.5 ZINC. | |
| 00000178 | GALV FLANGED KNURLED HEX CAP SCREW 8.8 M6x16 | VITE AQ 8.8 M6x16 TE FLANG. ZIGR. ZINC. BIANCO | |
| 00000194 | GALV 10 HEX HEAD CHIPBOARD SCREW 6X20 | VITE TRUCIOL. 6x20 T.ES.10 ZIN DIN571 | |
| 00300017 | S/S SELF-LOCKING NUT M4 LOW DIN 982 | DADO AUTOBLOC INOX M4 BASSO DIN985 | |
| 03000392 | BOILER SUPPORT MAC96 | SUPPORTO CALDAIA MAC96 AGG.13/03/2006 | |
| 03001954 | BASE ALIGNMENT PLATE 2GR APPIA | LAMIERA ALLINEAMENTO BASAMENTO2GR. APPIA | |
| 03002530 | GAUGE SUPPORT AURELIA II | STAFFA SUP. MANOM. AURELIA II | |
| 03002990 | GUIDE SWITCH DIN 55MM | GUIDA TELERUTTORE DIN 55mm | |
| 03003012 | GROUP HOLDER PANEL APPIA II 2 GR | PARETE PORTAGR. 2GR. APPIA II | |
| 03003013 | GROUP HOLDER PANEL APPIA II 3 GR | PARETE PORTAGR. 3GR. APPIA II | |
| 03003044 | BOILER SUPPORT APPIA 2GR/APPIA II 2 GR-COMPACT | LAMIERA SUPPORTO CALDAIA APPIA 2GR/APPIA II2GR-CC | |
| 03003060 | LEFT STEAM TAP SUPPORT APPIA II | SUPP. RUB. VAPORE SX STAMPATA APPIA II | |
| 03003061 | RIGHT STEAM TAP SUPPORT APPIA II | SUPP. RUB. VAPORE DX STAMPATA APPIA II | |
| 03003097 | RIGHT SIDE FRAME APPIA19 | FIANCO DX STAMPATO TELAIO APPIA19 | |
| 03003098 | LEFT SIDE FRAME APPIA19 | FIANCO SX STAMPATO TELAIO APPIA19 | |
| 03003108 | COMMAND SUPPORT PLATE 2GR APPIA19 | LAMIERA SUPP.INVOLUCRO COMANDI 2GR. APPIA19 | |
| 03003109 | COMMAND SUPPORT PLATE 3GR APPIA19 | LAMIERA SUPP.INVOLUCRO COMANDI 3GR. APPIA19 | |
| 03003116 | SUPERIOR BACKSIDE L PLATE 2GR APPIA19 | LAMIERA L SUP. POSTERIORE 2GR. APPIA19 | |
| 03003117 | SUPERIOR BACKSIDE L PLATE 3GR APPIA19 | LAMIERA L SUP. POSTERIORE 3GR. APPIA19 | |
| 03003142 | INFERIOR FRONTSIDE FRAME APPIA19 3GR | CARENA INF. FRONTALE APPIA19 3GR. | |
| 03003146 | INFERIOR BACKSIDE FRAME APPIA19 3GR | CARENA INF. POSTERIORE APPIA19 3GR. | |
| 03003153 | MAIN BASE 3GR APPIA19 | BASAMENTO PORTANTE 3GR APPIA19 | |
| 03003158 | SHEET L LOWER FRONT 3GR. APPIA19 | LAMIERA L INF.ANTERIORE 3GR. APPIA19 | |
| 03003630 | STAFF SUPPORT CLAMP AURELIA18 | STAFFA SUPP. MORSETTIERA AURELIA18 | |
| 05000083 | CABLE LOCK SR 11-2 BLACK | BLOCCACAVO SR 11-2 NERO | |
| 05000085 | CABLEGLAND TEC-S M20 D.7-14 CON DADO P-CT M20 Es | PRESSACAVO TEC-S M20 D.7-14 PLASTICA NERO | |
| 05000235 | CLAMP COVER FOR WIRING | COPRI MORSETTO CABLAGGI | |
| 05002210 | FLAT ANGULAR DRIP TRAY SUPPORT | SUPPORTO ANGOLARE PIATTO RACCOGLIACQUA | |
| 05002490 | CENTRAL BOARD SUPPORT BOX APPIA19 | SCATOLA SUPPORTO CENTRALINA APPIA19 | |
| 05002492 | CENTRAL BOARD SUPPORT BOX COVER APPIA19 | COPERCHIO SCATOLA SUPPORTO CENTRALINA APPIA19 | |
| 05002494 | SWITCH SUPPORT BOX APPIA19 | SCATOLA SUPPORTO TELERUTTORE APPIA19 | |
| 05002502.BV | BASE 2GR. APPIA19 - PAINTED WHITE | BASAMENTO 2GR. APPIA19 BIANCO VERNICIATO | |
| 05002502.N | BASE 2GR. APPIA19 - BLCK | BASAMENTO 2GR. APPIA19 NERO FOTOINCISO | |
| 05002502.NOV | BASE 2GR. APPIA19 - PAINTED MATTE BLACK | BASAMENTO 2GR. APPIA19 NERO OPACO VERNICIATO | |

| COD. | DESCRIPTION | DESCRIZIONE | VAL. |
|--------------|---|--|------|
| 05002502.RV | BASE 2GR. APPIA19 - PAINTED RED | BASAMENTO 2GR. APPIA19 ROSSO VERNICIATO | |
| 05002538.BV | RIGHT INFERIOR SIDE PANEL 3GR - PAINTED WHITE | FIANCO INFERIORE DX APPIA19 3GR BIANCO VERN. | |
| 05002538.NOV | RIGHT INFERIOR SIDE PANEL 3GR - PAINTED MATTE BLC | FIANCO INFERIORE DX APPIA19 3GR NERO OPACO VERN. | |
| 05002538.RV | RIGHT INFERIOR SIDE PANEL 3GR - PAINTED RED | FIANCO INFERIORE DX APPIA19 3GR ROSSO VERN. | |
| 05002539.BV | LEFT INFERIOR SIDE PANEL 3GR - PAINTED WHITE | FIANCO INFERIORE SX APPIA19 3GR BIANCO VERN. | |
| 05002539.NOV | LEFT INFERIOR SIDE PANEL 3GR - PAINTED MATTE BLAC | FIANCO INFERIORE SX APPIA19 3GR NERO OPACO VERN. | |
| 05002539.RV | LEFT INFERIOR SIDE PANEL 3GR - PAINTED RED | FIANCO INFERIORE SX APPIA19 3GR ROSSO VERN. | |
| 07300196 | FRAME HINGE M4 ES 6 | PERNO CARENA M4 ES 6 | |
| 07300391 | EXTENSION CUP WARMER FIXING VA358 | PROLUNGA FISSAGGIO SCALDATAZZE VA358 | |
| 40000010 | NUT M6 W/ WELDED GALV WASHER | DADO AQ M6 RONDELLA SALDATA ZINCATO | |
| 40302029 | SHEET METAL RELAY ATHENA 2-3GR. | LAMIERA SICUREZZA RELE' ATHENA 2-3 GR. | |
| 98001006 | MACHINE FOOT 06 BICOMPONENT D48H40 INSERT M10 | PIEDE MACCHINA 06 BICOMPONENTE D.48 H=40 INSERTO | |
| R98001006 | KIT-MACHINE FOOT 06 BICOMPONENT D48H40 - 2Pcs | KIT-PIEDE MACCHINA BICOMPONENTE D.48 H=40 - 2Pz | |
| 98001008 | KIT TALL FEET 2006 (4 PCS.) | KIT PIEDI ALTI 2006 (4 pz.) | |

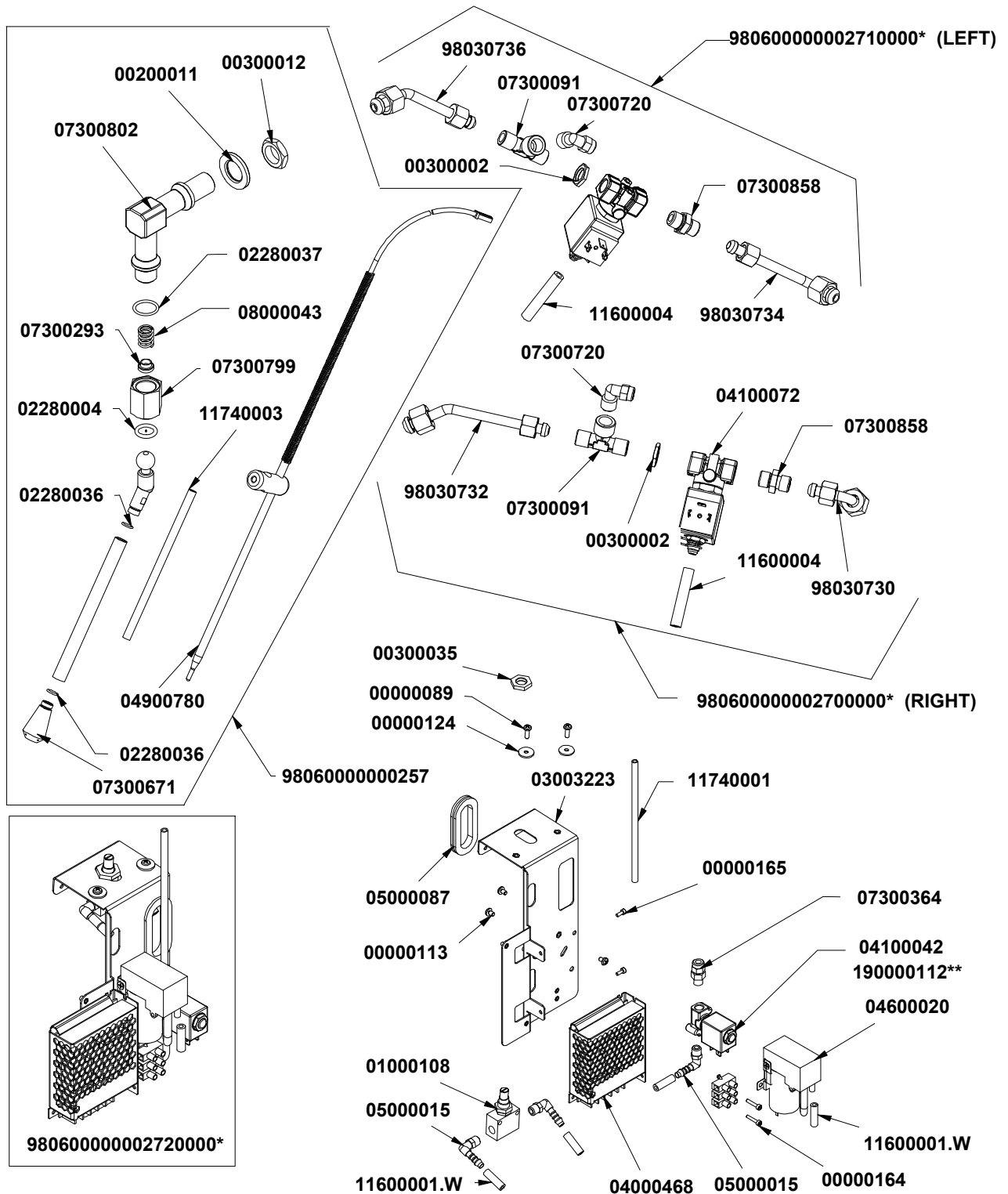

| CODE | DESCRIPTION | DESCRIZIONE |
|----------|-------------------|----------------------|
| 04001510 | Wiring Easy Cream | Cablaggio Easy Cream |

* Specificare versione
 Specify version

| COD. | DESCRIPTION | DESCRIZIONE | VAL. |
|------------|--|---|------|
| 11740001 | TEFLON PIPE 6/4 | TUBO TEFLON 6/4 | |
| 00000089 | S/S CROSSHEAD CAP SCREW M4x12 DIN7985 | VITE INOX M4x12 TC TCR DIN7985 | |
| 00000113 | S/S CROS SHEAD CAP SCREW M4x6 7985 | VITE INOX M4x6 TC TCR 7985 | |
| 00000124 | GALV WASHER D4 3x16x1.5 | RONDELLA AQ D4.3x16x1.5 ZINC. | |
| 00000164 | S/S SCREW M3x16 TCEI ISO 4762 | VITE INOX M3x16 TCEI ISO 4762 | |
| 00000165 | S/S SCREW M3x8 TCEI ISO 4762 | VITE INOX M3x8 TCEI ISO 4762 | |
| 00200011 | GALV WASHER M16 17x30x3 | RONDELLA AQ M16 17x30x3 ZINC | |
| 00300002 | BRASS NUT 1/4 D3 CH18 | DADO OT 1/4 SPESS.3 CH18 AGG. 22.07.96 | |
| R00300002 | KIT-BRASS NUT 1/4 D3 - 15Pcs | KIT-DADO OT 1/4 SPESS.3 - 15Pz | |
| 00300012 | BRASS NUT 3/8 GAS D6 CH22 ADD 22.07.96 | DADO OT 3/8 GAS SPESS.6 CH22 AGG. 22.07.96 | |
| 00300035 | OT NUT M12X1 CH19 FOR FIXING GAS VALVE APPIA | DADO OT M12x1 CH19 x FISSAGGIO VALVOLA APPIA GAS | |
| 01000108 | TAP MRF 1/8 FF 604 | RUBINETTO MRF 1/8 F-F 604 | |
| 02280004 | GASKET O RING 115 D17 EP 856 x SWIVEL STEAM PIPE | GUARN. OR 115 D.17 EP856 SNODO LANCIA | |
| R02280004 | KIT-GASKET O RING 115 D17 EP 856 x STEAM PIPE - 55Pcs | KIT-GUARN. OR 115 D.17 EP856 SNODO LANCIA - 55Pz | |
| 02280036 | O RING FOR STEAM WAND NOZZLE D6x1.2 EPDM70 500 F | GUARN. OR x BECCO LANCIA VAP. DI 6x1.2 EPDM70(CONF | |
| R02280036 | KIT-O RING FOR STEAM WAND NOZZLE D6x1.2 EPDM - 65Pcs | KIT-GUARN. OR x BECCO LANCIA VAP. D. 6x1.2 EPDM- 65P | |
| 02280037 | GASKET O RING JOINT LOCK 16x2 NBR70 | GUARN. OR CHIUSURA SNODO 16x2 NBR70 | |
| R02280037 | KIT-GASKET O RING JOINT LOCK 16x2 NBR - 45Pcs | KIT-GUARN. OR CHIUSURA SNODO 16x2 NBR - 45Pz | |
| 03003223 | COMPRESSOR SUPPORT PLATE VA358 | LAMIERA SUPPORTO COMPRESSORE VA388 | |
| 04000468 | TRANSFORMER 24VDC 50W OPTIONAL AURELIA18 LRS 5 | TRASFORMATORE 24V 50W OPTIONALS AURELIA18LRS-5 | |
| R04000468 | KIT-TRANSFORMER 24VDC 50W Opt. - 1Pcs | KIT-TRASFORMATORE 24V 50W-1 PZ | |
| 04001510 | EXTRA WIRING EASYCREAM APPIA19 | SUPPL. CABLAGGIO EASY CREAM APPIA19 | |
| 04100042 | 2WAY SOLENOID 1/8-1/8 220-230V50/60Hz F2 CE TH1xM4 | E.V. NC 2VIE 1/8-1/8 220-230V 50/60Hz VITON F2 CEPIEDIN(C | |
| R04100042 | KIT-2WAY SOLENOID 1/8-1/8 220-230V50/60Hz F2 CE - 1Pcs | KIT-E.V. NC 2VIE 1/8-1/8 220-230V 50/60Hz VITON F2- 1Pz | |
| 04100072 | 3WY SOLENOID 1/4-1/4 DISCHARGE 1/8 208/240V 50/60Hz | E.V. NC 3VIE 1/4-1/4 SCAR.1/8 208/240V 50/60Hz F5INOX | |
| 04600020 | MICROCOMPRESSOR EASYCREAM TALENTO/AURELIA II | MICROCOMPRESSORE x EASY CREAM TALENTO / AURELI | |
| 04900780 | PROBE PT1000 STEAMWAND TURBOCREAM D06 +SUP A | SONDA PT1000 x LANCIA VAP. DRITTA + SUPP. ADONIS**A | |
| 05000015 | TUBE FASTENING WES 6R 1/8 | RACCORDO PORTATUBO WES 6R 1/8 | |
| 05000087 | CABLE DUCT PVC OVALE NERO OV7 | PASSACAVO PVC OVALE NERO OV7 | |
| 07300091 | T FITTING MFM 1/4 CYLIN. | RACCORDO T 1/4 M-F-M CILIN. | |
| 07300293 | ARTICULATED BUSHING AG.25.06.96 OT-57 | BUSSOLA SNODO AG.25.06.96 OT-57 | |
| R07300293 | KIT-ARTICULATED BUSHING - 15Pcs | KIT-BUSSOLA SNODO - 15Pz | |
| 07300364 | STRAIGHT FITTING 1/8 M CON. - FITTING.6 340 | RACCORDO DIR. 1/8 M CON. - CALZAM.6 340 | |
| R07300364 | KIT-STRAIGHT FITTING 1/8 M CON. - FITTING.6 340 - 8Pcs | KIT-RACCORDO DIR. 1/8 M CON. - CALZAM.6 - 8Pz | |
| 07300671 | EASYCREAM NOZZLE 4HOLES TALENTO - AURELIA II | BECCO EASYCREAM 4 FORI TALENTO / AURELIA II | |
| 07300720 | L FITTING 1/4 M - FITTINGS | RACCORDO L 1/4 M - CALZAM. | |
| 07300799 | NUT FITTING 3/8 H=26 S/S ARTICULATED WAND | DADO RACC. 3/8 H=26 LANCIA SNODATA INOX | |
| 07300802 | ATTACHMENT HOT WATER TAP/AUTOSTEAM AURELIA II | ATTACCO RUB. ACQUA/AUTOSTEAM AURELIA II OT-57 | |
| 07300858 | FITTING 1/4M-1/4M OT-57 USA | RACCORDO 1/4M-1/4M OT-57 USA | |
| R07300858 | KIT-FITTING 1/4M-1/4M - 15Pcs | KIT-RACCORDO 1/4M-1/4M - 15Pz | |
| 08000043 | SPRING FOR ARTICULATED WAND D.1.6 D.11.9x16.2 4CO | MOLLA PER LANCIA SNODATA FILO D.1.6 D.11.9x16.2 4SPIL | |
| R08000043 | KIT-SPRING FOR ARTICULATED WAND D.1.6 D.11.9x16.2 | KIT-MOLLA PER LANCIA SNODATA FILO D.1.6 D.11.9x16.- 1 | |
| 11600001.W | WHITE SILICONE PIPE 4x7,5 60Sh(1mt=41gr) PLATINICO S | TUBO SILICONE BIANCO4x7,5 60Sh(1mt=41gr) PLATINICO S | |
| 11600004 | SILICONE PIPE 5x9 60Sh PEROX WHITE SEMITRASPAREN | TUBO SILICONE 5x9 70Sh PEROX TRASPARENTE(1mt=50gr) | |
| 11740003 | CALIBRATED TEFLON PIPE 6/4 | TUBO TEFLON NSF 6/4 CALIBRATO1 matassa = 50mt | |

| COD. | DESCRIPTION | DESCRIZIONE | VAL. |
|--------------------|---|--|------|
| 190000112 | 2 WAYS SOLENOID 1/8-1/8 208-240V 60Hz FKM F2 UL NSF | E.V. NC 2VIE 1/8-1/8 208-240V 60Hz FKM F2 UL NSF 121WH | |
| 98030730 | E.V. BOILER PIPE EASY CREAM RIGHT APPIA19 2-3GR. | TUBO CALDAIA-E.V. EASY CREAM DX APPIA19 2-3GR. | |
| 98030732 | E.V. EASY CREAM PIPE - RIGHT WAND APPIA19 2-3GR. | TUBO E.V. EASY CREAM - LANCIA DX APPIA19 2-3GR. | |
| 98030734 | E.V.-BOILER PIPE LEFT EASY CREAM APPIA19 2-3GR. | TUBO CALDAIA-E.V. EASY CREAM SX APPIA19 2-3GR. | |
| 98030736 | E.V. EASY CREAM PIPE - LEFT WAND APPIA19 2-3GR. | TUBO E.V. EASY CREAM - LANCIA SX APPIA19 2-3GR. | |
| 98060000000257 | ATTACHMENT + EASYCREAM WAND W/ PROBE SET APP | ASS. ATTACCO + LANCIA EASY CREAM CON SONDA APPIA/ | |
| 980600000002700001 | SOLENOID + RIGHT STEAM TUBES SET RIGHT EC | ASS. E.V. + TUBI VAPORE DX EASY CREAM DX | |
| 980600000002710001 | SOLENOID + LEFT STEAM TUBES SET LEFT EC | ASS. E.V. + TUBI VAPORE SX EASY CREAM SX | |
| 980600000002720001 | SUPPORT + EASYCREAM SOLENOID SET CE | ASS. SUPPORTO+ E.V. EASY CREAM CE | |
| 980600000002720002 | SUPPORT SET + SOLENOID EASY CREAM CSA | ASS. SUPPORTO+ E.V. EASY CREAM CSA | |
| 980600000002720003 | SUPPORT SET + SOLENOID EASY CREAM 115V | ASS. SUPPORTO+ E.V. EASY CREAM 115V | |

VOL

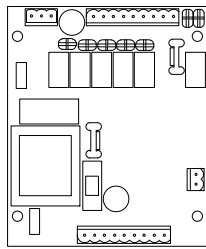

04901430

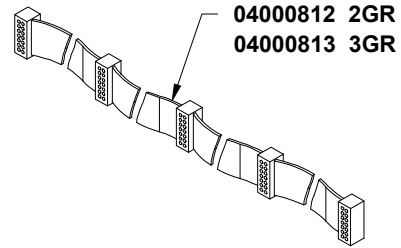

04000812 2GR
04000813 3GR

XT - TIMER

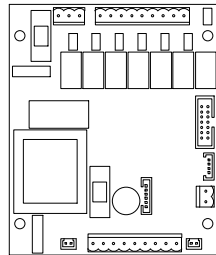

04901432

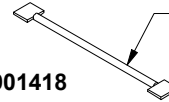

04001524

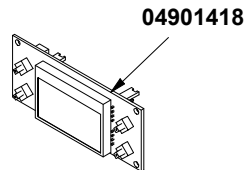

04901418

SEM

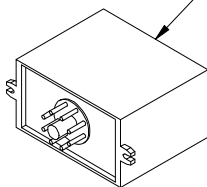

09000015
09000015.UL**

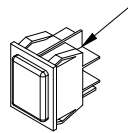

04200012

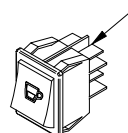

04200116

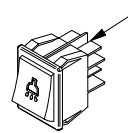

04200118

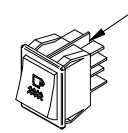

04200120

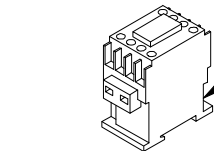

04200019



05000083



05000085



04200057

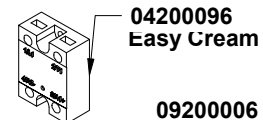

04200096
Easy Cream

09200006

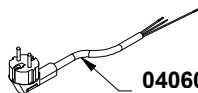

04060015 2GR**
04060014 3GR**

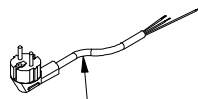

04000126 230V 2GR 3000W

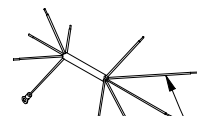

04000543 400V
04000542 230V 2GR 4500W

| ELECTRICAL COMPONENTS | | |
|-----------------------|----------------------------|-------------------------------|
| CODE | DESCRIPTION | DESCRIZIONE |
| 04001510 | Wiring Easy Cream | Cablaggio Easy Cream |
| 04001512 | Wiring SEM 2GR | Cablaggio SEM 2GR |
| 04001513 | Wiring SEM 3GR | Cablaggio SEM 3GR |
| 04001517 | Wiring VOL 2GR | Cablaggio VOL 2GR |
| 04001518 | Wiring VOL 3GR | Cablaggio VOL 3GR |
| 04000340 | Bridge trasf. 380V - 220V | Ponticello trasf. 380V - 220V |
| 04000806 | Cup warmer wiring | Cablaggio scaldatasse |
| 04000807.P | Push-button wiring SEM 2GR | Cablaggio puls. SEM 2GR |
| 04000809.P | Push-button wiring SEM 3GR | Cablaggio puls. SEM 3GR |

**North America Market
Mercato Nord America

| COD. | DESCRIPTION | DESCRIZIONE | VAL. |
|-------------|--|---|------|
| 04000126 | ELECTRIC CABLE 2MT CE SCHUKO PLUG 90° 3X1,5 | CAVO ELETTR. 2mt CE SPINA SCHUKO 90° 3x1,5 H05VV-F | |
| 04000340 | BRIDGE TRANSFORMATION 380V TO 220V AURELIA-APPIA | PONTICELLO TRASF. ALIMENTAZ. DA 380V A 230VAURELIA/ | |
| 04000542 | ELECTRICAL CABLE 3x4 H07RN-F 2mt450/750V CB ICEL | CAVO ELETTR. 3x4 H07RN-F 2mt450/750V CB -> ICEL <- | |
| 04000543 | ELEC. CABLE 5x2,5 H07RN-F CB450/750V 2,5mt ICEL | CAVO ELETTR. 5x2,5 H07RN-F CB450/750V 2,5mt ICEL | |
| 04000806 | WIRING CUPWARMER 2-3 GR APPIA | CABLAGGIO SCALDATAZZE 2-3 GR. APPIA | |
| 04000807.P | WIRING PUSH-BUTTON PANEL 2/3 GR APPIA S | CABLAGGIO PULSANTIERA 2 GR APPIA S | |
| 04000809.P | WIRING PUSH-BUTTON PANEL 3 GR S APPIA | CABLAGGIO PULSANTIERA 3 GR. S APPIA | |
| 04000812 | CABLE 14 WAY KEYPAD 2GR APPIA + SHEATH | CAVO 14 VIE COLL.PULSANTIERA 2GR APPIA + GUAINA | |
| R04000812 | KIT-CABLE 14 WAY KEYPAD 2GR + SHEATH - 2Pcs | KIT-CAVO 14 VIE COLL.PULSANTIERA 2GR - 2Pz | |
| 04000813 | CABLE 14 WAY KEYPAD 3GR APPIA + SHEATH | CAVO 14 VIE COLL.PULSANTIERA 3GR APPIA + GUAINA | |
| R04000813 | KIT-CABLE 14 WAY KEYPAD 3GR + SHEATH - 2Pcs | KIT-CAVO 14 VIE COLL.PULSANTIERA 3GR - 2Pz | |
| 04001510 | EXTRA WIRING EASYCREAM APPIA19 | SUPPL. CABLAGGIO EASY CREAM APPIA19 | |
| 04001512 | COMPLETE WIRING 2GR S APPIA19 | CABLAGGIO COMP. 2GR S APPIA19 | |
| 04001513 | WIRING SEM 3GR | CABLAGGIO COMP. 3GR S APPIA19 | |
| 04001517 | COMPLETE WIRING 2GR V APPIA19 | CABLAGGIO COMP. 2GR V APPIA19 | |
| 04001518 | WIRING VOL 3GR | CABLAGGIO COMP. 3GR V APPIA19 | |
| 04001524 | CONN CABLE DISPLAY-CENTRAL BOARD APPIA19 | CAVO COLL. DISPLAY-CENTRALINA APPIA19 | |
| 04060014 | CABLE+PLUG AWG3x12 SJO UL/CSA 30A 250V NEMAL6-3 | CAVO ALIM. AWG3x12 SJO 90°C UL/CSA 2mt SPINA USADR | |
| 04060015 | CABLE+PLUG AWG3x14 SJO UL/CSA 20A 250V NEMA 6-2C | CAVO ALIM. AWG3x14 SJO 90°C UL/CSA 2mt SPINA USADR | |
| 04200012 | RED FLASHING SEGNA SYSTEM UL | SEGNALATORE LUMINOSO ROSSO RETTANGOLARE UL | |
| 04200019 | 4POLE CONTACTOR 25A CE/UL 230V COIL | CONTATTORE QUADRIPOLORE 25A CE/UL BOBINA 230V | |
| R04200019 | KIT-4POLE CONTACTOR 25A CE/UL 230V COIL - 1Pcs | KIT-CONTATTORE QUADRIPOLORE 25A CE/UL BOBINA 230V | |
| 04200057 | DBL POWER BIPOLAR BIG SWITCH 10A UL 22X19 AURELIA | INTERRUT. ACCENSIONE BIPOL. GRANDE 10A UL 22x19AL | |
| R04200057 | KIT-DBL POWER BIPOLAR BIG SWITCH 10A UL 22X19 - 15 | KIT-INTERRUT. ACCENSIONE BIPOL. GRANDE 10A UL 22x19 | |
| 04200096 | STATIC RELAY 25A 250V 1OUT | RELE' STATICO 25A 250V 1out | |
| R04200096 | KIT-STATIC RELAY 25A 250V 1OUT-1Pcs | KIT -RELE' STATICO 25A 250V 1OUT-1PZ | |
| 04200116 | BLUE LIGHT WHITE BIPOLAR SWITCH UL 16A COFFEE | INTERRUTTORE BIPOLARE LUMINOSO BIANCO RETTANGOLARE | |
| 04200118 | BLUE LIGHT WHITE BIPOLAR SWITCH UL 16A HOTWATER | INTERRUTTORE BIPOLARE LUMINOSO BIANCO RETTANGOLARE | |
| 04200120 | BLUE LIGHT WHITE BIPOLAR SWITCH UL 16A CUPWARMER | INTERRUTTORE BIPOLARE LUMINOSO BIANCO RETTANGOLARE | |
| 04901418 | DISPLAY BOARD APPIA19 XT | SCHEDA DISPLAY APPIA19 XT | |
| 04901430 | UNIVERSAL CENTRAL BOARD 230V APPIA LIFE | CENTR. UNIVERSALE APPIA Life 230V | |
| 04901432 | UNIVERSAL CENTRAL BOARD 115-240V APPIA LIFE XT | CENTR. UNIVERSALE APPIA LIFE XT 100-240V | |
| 05000083 | CABLE LOCK SR 11-2 BLACK | BLOCCACAVO SR 11-2 NERO | |
| 05000085 | CABLEGLAND TEC-S M20 D.7-14 CON DADO P-CT M20 Es | PRESSACAVO TEC-S M20 D.7-14 PLASTICA NERO | |
| 09000015 | AUTOLEVEL CONTROL BOARD 230V | CENTRALINA AUTOLIVELLO 230V | |
| 09000015.UL | AUTOLEVEL CONTROL BOARD UL 230V | CENTRALINA AUTOLIVELLO UL 230V | |
| 09200006 | MACHINE PRESSO GAUGE CE/UL TRIF. 30A 400V 0,5-1,4E | PRESSOSTATO MACCHINA CE/UL TRIF. 30A 400V,0,5-1,4BA | |
| R09200006 | KIT-MACHINE PRESSO GAUGE CE/UL TRIF. 30A 400V - 1P | KIT-PRESSOSTATO MACCHINA CE/UL TRIF. 30A 400V- 1Pz | |

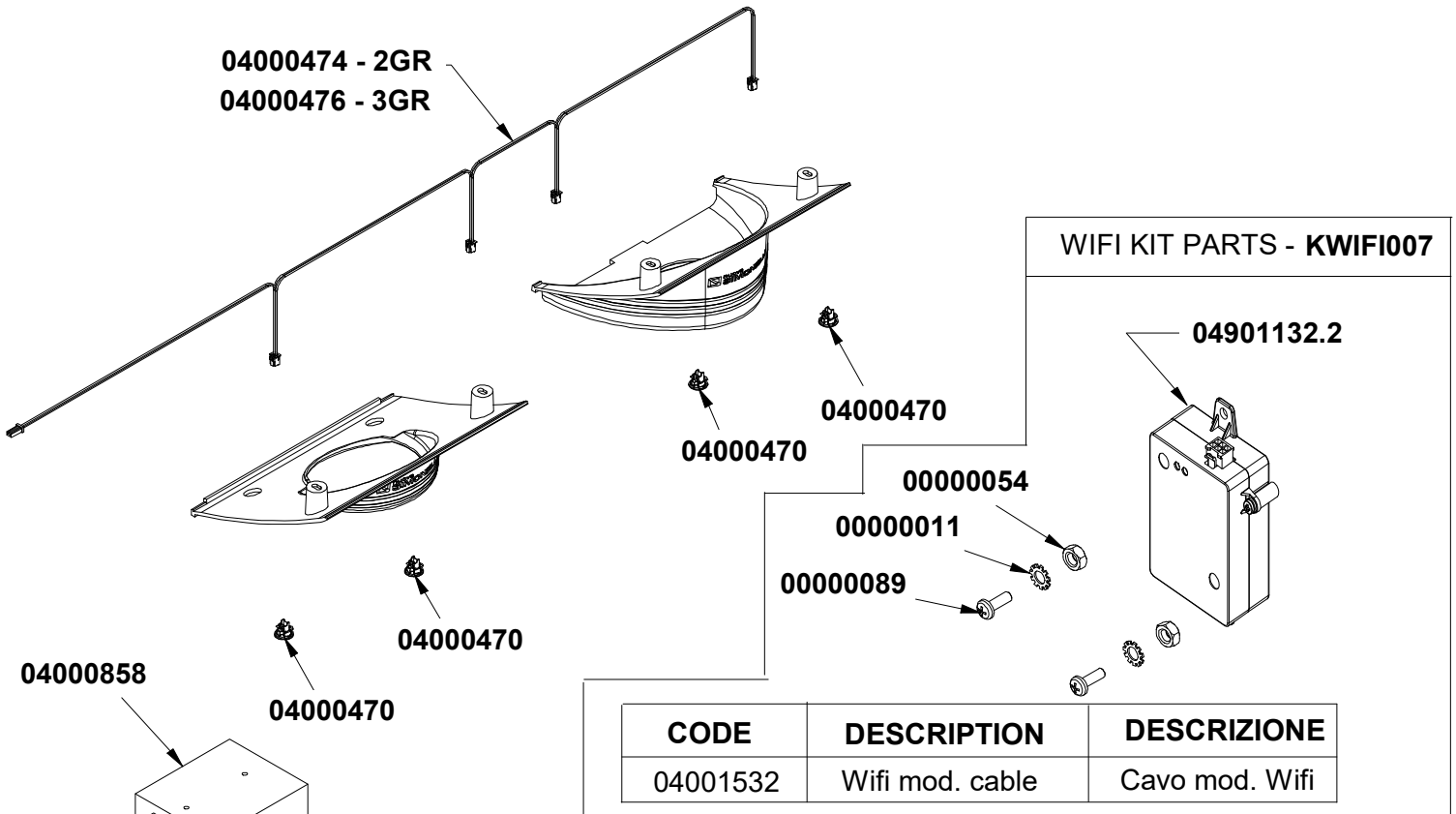

| CODE | DESCRIPTION | DESCRIZIONE |
|----------|-----------------|----------------|
| 04001532 | Wifi mod. cable | Cavo mod. Wifi |

| CODE | DESCRIPTION | DESCRIZIONE |
|----------|----------------------------|----------------------|
| 04000474 | Lights wiring 2GR | Cablaggio luci 2GR |
| 04000476 | Lights wiring 3GR | Cablaggio luci 3GR |
| 04001508 | Lights power supply wiring | Cablaggio alim. luci |

| COD. | DESCRIPTION | DESCRIZIONE | VAL. |
|------------|--|---|------|
| 00000011 | S/S KNURLED WASHER M4 UNI8842/A | RONDELLA INOX M4 ZIGRINATA UNI8842/A | |
| 00000054 | GALV HIGH NUT M4 | DADO AQ M4 ALTO ZINCATO | |
| 00000089 | S/S CROSSHEAD CAP SCREW M4x12 DIN7985 | VITE INOX M4x12 TC TCR DIN7985 | |
| 04000470 | 12VDC LED SPOT AURELIA WAVE | LED AURELIA18 12V | |
| R04000470 | KIT-12VDC LED SPOT AURELIA WAVE-2Pcs | KIT -LED AURELIA18 12V-2PZ | |
| 04000474 | GROUP LIGHTS WIRING AURELIA WAVE 2GR | CABLAGGIO LUCI GRUPPI EROGAZ. 2GR. AURELIA18 | |
| 04000476 | GROUP LIGHTS WIRING AURELIA WAVE 3GR | CABLAGGIO LUCI GRUPPI EROGAZ. 3GR. AURELIA18 | |
| 04000858 | TRASF. LED RETRO IN:100/240V OUT:12V CE/UL 15W RS- | TRASF. LED RETRO IN:100/240V OUT:12V CE/UL 15WRS-1E | |
| R04000858 | KIT-TRASF. REAR LED IN:100/240V OUT:12V CE/UL - 1Pcs | KIT-TRASF. LED RETRO IN:240V OUT:12V CE/UL 15W- 1Pz | |
| 04001508 | POWER WIRING TRANS.LED-WIFI APPIA19 | CABLAGGIO ALIMENTAZ.TRASF.LUCI-WiFi APPIA19 | |
| 04001532 | WIFI2020 MODULE CABLE - MAIN BOARD | CAVO MODULO WIFI2020 - CENTR. APPIA19 | |
| 04901132.2 | WIFI KIT 2020 APPIA LIFE | MODULO WIFI2020 APPIA LIFE | |
| KWIFI007 | WIFI2020 MODULE KIT APPIA LIFE | KIT MODULO WiFi 2020 APPIA LIFE | |

www.nuovasimonelli.it

Simonelli Group

Via E. Betti, 1
62020 Belforte del Chienti
Macerata - Italy
T +39 07339501
info@simonelligroup.it
www.nuovasimonelli.it

Nuova Distribution Usa

6940 Salashan Pkwy, Bldg, A
Ferndale, WA 98248
T +1 3603662226
info@simonelliusa.com
www.simonelliusa.com

Nuova Simonelli Asia Pacific

61 Kaki Bukit Ave 1
#02-24 Shun Li Industrial Park
Singapore 417943
T +65 68410985
www.nuovasimonelliasiapacific.com

Nuova Distribution France

Hexapole - Actipole - Bat 5
Rue Maurice Herzog
73420 Viviers Du Lac
T +33 (0) 967894852
info@nuovadistribution.fr